

HORIZONTAL DEFLECTION TRANSISTOR

...specifically designed for use in large screen color deflection circuits.

FEATURES:

- * Collector-Emitter Sustaining Voltage -
 $V_{CEX} = 1300 \text{ V (Min.) - BU207}$
 $= 1500 \text{ V (Min.) - BU208}$
- * Glassivated Base-Collector Junction

MAXIMUM RATINGS

Characteristic	Symbol	BU207	BU208 BU208A	Unit
Collector-Emitter Voltage	V_{CEO}	600	700	V
Collector-Emitter Voltage	V_{CEX}	1300	1500	V
Emitter-Base Voltage	V_{EBO}	5.0		V
Collector Current - Continuous - Peak	I_C	5.0 7.5		A
Base Current - Continuous	I_B	2.5		A
Total Power Dissipation @ $T_C=25^\circ\text{C}$ Derate above 25°C	P_D	55 0.611		W W/ $^\circ\text{C}$
Operating and Storage Junction Temperature Range	T_J, T_{STG}	- 65 to +115		$^\circ\text{C}$

THERMAL CHARACTERISTICS

Characteristic	Symbol	Max	Unit
Thermal Resistance Junction to Case	$R_{\theta JC}$	1.64	$^\circ\text{C/W}$

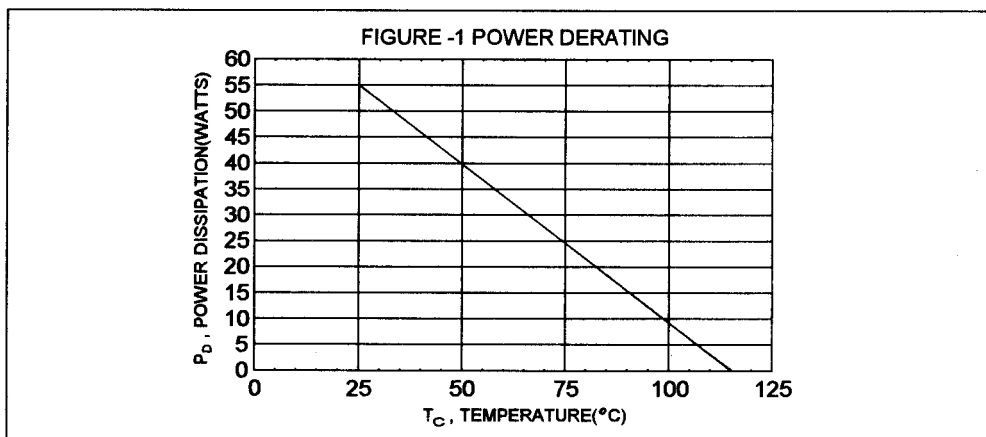

NPN
BU207
BU208
BU208A

5.0 AMPERE
POWER
TRANSISTORS
1300-1500 VOLTS
55 WATTS

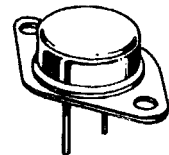

TO-3

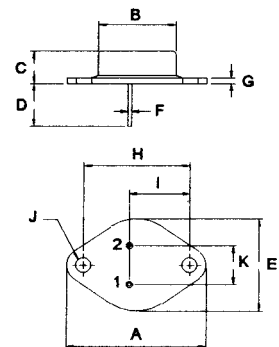

PIN 1. BASE
 2. EMITTER
 COLLECTOR(CASE)

DIM	MILLIMETERS	
	MIN	MAX
A	38.75	39.96
B	19.28	22.23
C	7.96	9.28
D	11.18	12.19
E	25.20	26.67
F	0.92	1.09
G	1.38	1.62
H	29.90	30.40
I	16.64	17.30
J	3.88	4.36
K	10.67	11.18

ELECTRICAL CHARACTERISTICS ($T_c = 25^\circ\text{C}$ unless otherwise noted)

Characteristic	Symbol	Min	Max	Unit
----------------	--------	-----	-----	------

OFF CHARACTERISTICS

Collector - Emitter Sustaining Voltage (1) ($I_C = 100\text{ mA}$, $I_B = 0$)	BU207 BU208, BU208A	$V_{CEO(sus)}$	600 700	V
Collector Cutoff Current ($V_{CE} = 1300\text{ V}$, $V_{BE} = 0$) ($V_{CE} = 1500\text{ V}$, $V_{BE} = 0$)	BU207 BU208, BU208A	I_{CES}	1.0 1.0	mA
Emitter Cutoff Current ($V_{EB} = 5.0\text{ V}$, $I_C = 0$)		I_{EBO}	10	mA

ON CHARACTERISTICS (1)

DC Current Gain ($I_C = 4.5\text{ A}$, $V_{CE} = 5.0\text{ V}$)		h_{FE}	2.25	
Collector - Emitter Saturation Voltage ($I_C = 4.5\text{ A}$, $I_B = 2.0\text{ A}$)	BU207, BU208 BU208A	$V_{CE(sat)}$	5.0 1.0	V
Base - Emitter Saturation Voltage ($I_C = 4.5\text{ A}$, $I_B = 2.0\text{ A}$)		$V_{BE(sat)}$	1.5	V

DYNAMIC CHARACTERISTICS

Current Gain - Bandwidth Product ($I_C = 0.1\text{ A}$, $V_{CE} = 5.0\text{ V}$, $f = 1.0\text{ MHz}$)		f_T	4.0(typ)	MHz
Output Capacitance ($V_{CE} = 10\text{ V}$, $I_E = 0$, $f = 1.0\text{ MHz}$)		C_{ob}	125(typ)	pF

SWITCHING CHARACTERISTICS

Fall Time ($I_C = 4.5\text{ A}$, $I_{B1} = 1.8\text{ A}$, $L_B = 10\text{ uH}$)		t_f	1.0(typ)	us
--	--	-------	----------	----

(1) Pulse Test: Pulse width $\leq 300\text{ us}$, Duty Cycle $\leq 2.0\%$

COLLECTOR SATURATION REGION

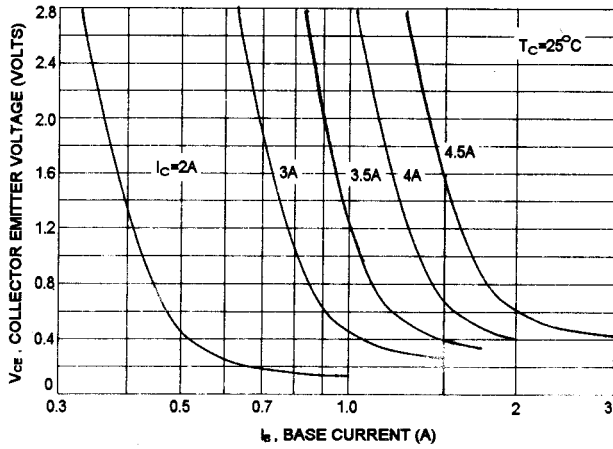

DC CURRENT GAIN

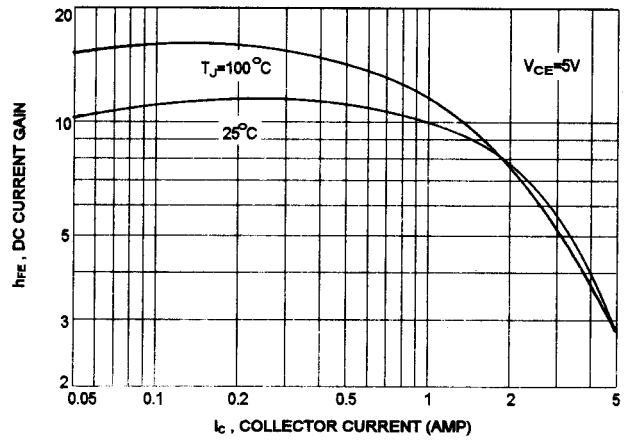

"ON" VOLTAGES

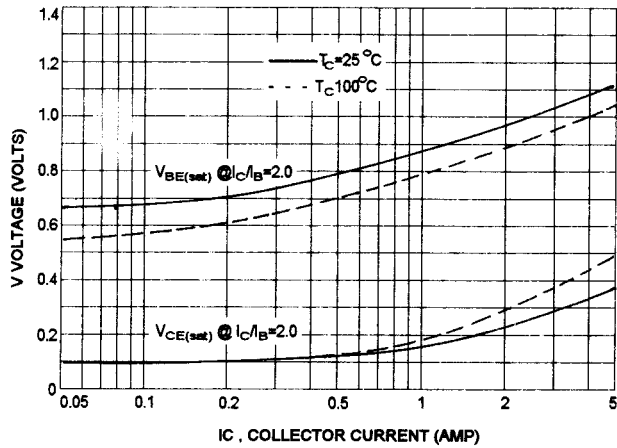

SWITCHING BEHAVIOR VERSUS ICM

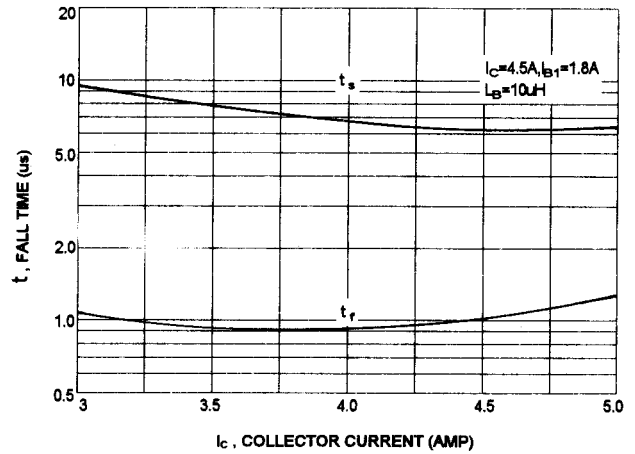

FORWARD BIAS SAFE OPERATING AREA

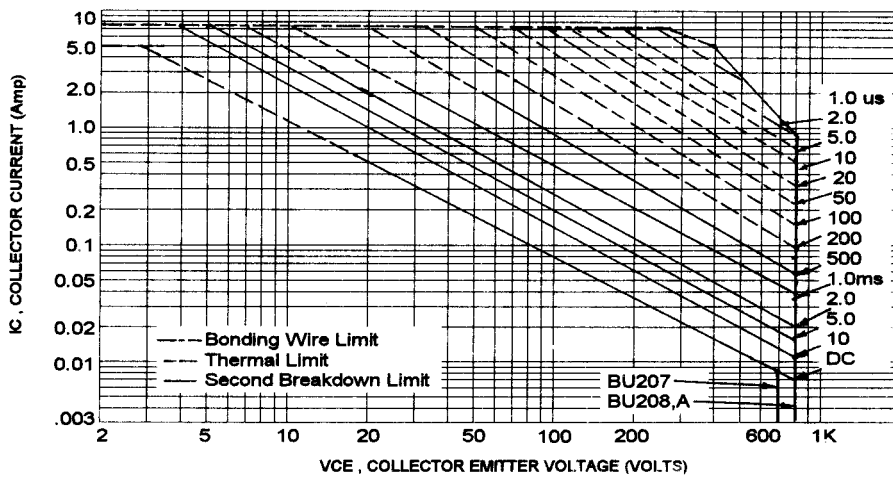



LittleDiode supplies new, hard to find or obsolete electronic components and semiconductors all over the world.

With over two million different components listed you are sure to find the part you need.

Feel free to visit us today at our online store:

LittleDiode.com

Looking forward to providing you with the best possible service.