

CQ202-4MS
CQ202-4NS

4.0 AMP TRIAC
600 THRU 800 VOLTS

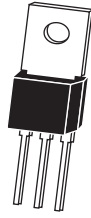

TO-202 THYRISTOR CASE

CentralTM
Semiconductor Corp.

DESCRIPTION:

The CENTRAL SEMICONDUCTOR CQ202-4MS series type is an Epoxy Molded Silicon Triac designed for full wave AC control applications featuring gate triggering in all four (4) quadrants.

MARKING CODE: FULL PART NUMBER

MAXIMUM RATINGS: ($T_C=25^\circ\text{C}$ unless otherwise noted)

	SYMBOL	CQ202 -4MS	CQ202 -4NS	UNITS
Peak Repetitive Off-State Voltage	V_{DRM}	600	800	V
RMS On-State Current ($T_C=80^\circ\text{C}$)	$I_T(\text{RMS})$		4.0	A
Peak One Cycle Surge ($t=10\text{ms}$)	I_{TSM}		40	A
I^2t Value for Fusing ($t=10\text{ms}$)	I^2t		2.4	A^2s
Peak Gate Power ($t_p=10\mu\text{s}$)	P_{GM}		3.0	W
Average Gate Power Dissipation	$P_G(\text{AV})$		0.2	W
Peak Gate Current ($t_p=10\mu\text{s}$)	I_{GM}		1.2	A
Storage Temperature	T_{stg}	-40 to +150		$^\circ\text{C}$
Junction Temperature	T_J	-40 to +125		$^\circ\text{C}$
Thermal Resistance	θ_{JA}		60	$^\circ\text{C}/\text{W}$
Thermal Resistance	θ_{JC}		7.5	$^\circ\text{C}/\text{W}$

ELECTRICAL CHARACTERISTICS: ($T_C=25^\circ\text{C}$ unless otherwise noted)

SYMBOL	TEST CONDITIONS	MIN	TYP	MAX	UNITS
I_{DRM}	Rated V_{DRM} , $R_{GK}=1\text{K}\Omega$			10	μA
I_{DRM}	Rated V_{DRM} , $R_{GK}=1\text{K}\Omega$, $T_C=125^\circ\text{C}$			200	μA
I_{GT}	$V_D=12\text{V}$, QUAD I, II, III		2.5	5.0	mA
I_{GT}	$V_D=12\text{V}$, QUAD IV		5.4	9.0	mA
I_H	$R_{GK}=1\text{K}\Omega$		1.6	5.0	mA
V_{GT}	$V_D=12\text{V}$, QUAD I, II, III, IV		0.95	1.75	V
V_{TM}	$I_{TM}=6.0\text{A}$, $t_p=380\mu\text{s}$		1.25	1.75	V
dv/dt	$V_D=2/3 V_{DRM}$, $T_C=125^\circ\text{C}$	11			$\text{V}/\mu\text{s}$

R4 (7-May 2004)

TO-202 THYRISTOR CASE - MECHANICAL OUTLINE

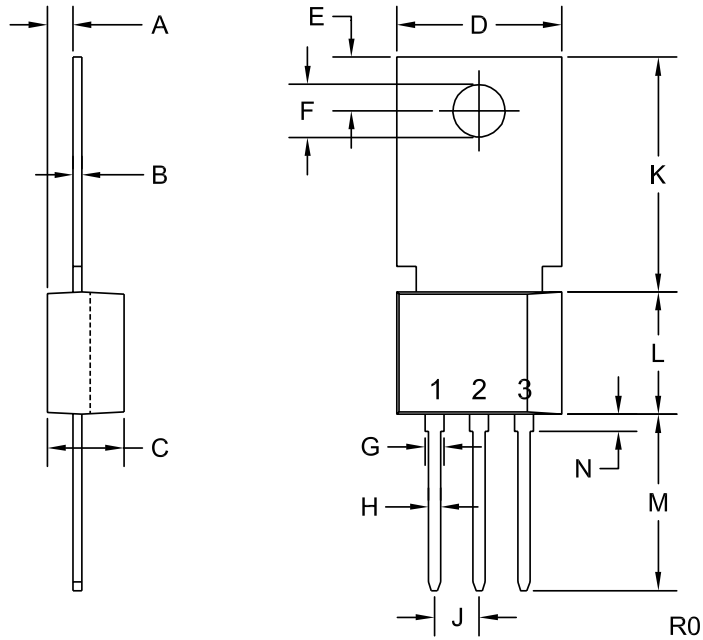

LEAD CODE:

- 1) MT1
- 2) MT2
- 3) GATE

NOTE: TAB IS COMMON
TO PIN 2 (MT2)

MARKING CODE:

FULL PART NUMBER

SYMBOL	DIMENSIONS		MILLIMETERS	
	MIN	MAX	MIN	MAX
A	0.057	0.061	1.45	1.55
B	0.019	0.021	0.49	0.52
C	0.175	0.180	4.44	4.56
D	0.376	0.388	9.55	9.85
E	0.118	0.134	3.00	3.40
F (DIA)	0.124	0.126	3.15	3.20
G	0.035	0.043	0.90	1.10
H	0.023	0.028	0.59	0.71
J	0.098	0.102	2.49	2.59
K	0.459	0.559	11.66	14.21
L	0.280	0.301	7.12	7.65
M	0.406	0.425	10.30	10.80
N	0.024	0.059	0.60	1.50

TO-202 Thyristor (REV: R0)



LittleDiode supplies new, hard to find or obsolete electronic components and semiconductors all over the world.

With over two million different components listed you are sure to find the part you need.

Feel free to visit us today at our online store:

LittleDiode.com

Looking forward to providing you with the best possible service.