

CMPT404A
SURFACE MOUNT
PNP SILICON
CHOPPER TRANSISTOR

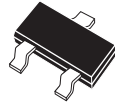

SOT-23 CASE

CentralTM

Semiconductor Corp.

DESCRIPTION:

The CENTRAL SEMICONDUCTOR CMPT404A type is an PNP silicon transistor manufactured by the epitaxial planar process, epoxy molded in a surface mount package, designed for chopper applications.

MARKING CODE: C2N

MAXIMUM RATINGS: ($T_A=25^\circ\text{C}$)

	SYMBOL		UNITS
Collector-Base Voltage	V_{CBO}	40	V
Collector-Emitter Voltage	V_{CEO}	35	V
Emitter-Base Voltage	V_{EBO}	25	V
Collector Current	I_C	150	mA
Power Dissipation	P_D	350	mW
Operating and Storage	T_J, T_{stg}	-65 to +150	$^\circ\text{C}$
Junction Temperature	θ_{JA}	357	$^\circ\text{C/W}$
Thermal Resistance			

ELECTRICAL CHARACTERISTICS: ($T_A=25^\circ\text{C}$ unless otherwise noted)

SYMBOL	TEST CONDITIONS	MIN	TYP	MAX	UNITS
I_{CBO}	$V_{CB}=10\text{V}$			100	nA
I_{EBO}	$V_{EB}=10\text{V}$			100	nA
BV_{CBO}	$I_C=10\mu\text{A}$	40			V
BV_{CEO}	$I_C=10\text{mA}$	35			V
BV_{EBO}	$I_E=10\mu\text{A}$	25			V
$V_{CE(SAT)}$	$I_C=12\text{mA}, I_B=400\mu\text{A}$			0.15	V
$V_{CE(SAT)}$	$I_C=24\text{mA}, I_B=1.0\text{mA}$			0.20	V
$V_{BE(SAT)}$	$I_C=12\text{mA}, I_B=400\mu\text{A}$			0.85	V
$V_{BE(SAT)}$	$I_C=24\text{mA}, I_B=1.0\text{mA}$			1.00	V
h_{FE}	$V_{CE}=0.15\text{V}, I_C=12\text{mA}$	100		400	
C_{ob}	$V_{CB}=6.0\text{V}, I_E=0, f=1.0\text{MHz}$		40		pF
t_d	$V_{CC}=10\text{V}, I_C=10\text{mA}, I_{B1}=1.0\text{mA}$		150		ns
t_r	$V_{CC}=10\text{V}, I_C=10\text{mA}, I_{B1}=1.0\text{mA}$		400		ns
t_s	$V_{CC}=10\text{V}, I_C=10\text{mA}, I_{B1}=I_{B2}=1.0\text{mA}$		3.0		μs
t_f	$V_{CC}=10\text{V}, I_C=10\text{mA}, I_{B1}=I_{B2}=1.0\text{mA}$		750		ns

SOT-23 CASE - MECHANICAL OUTLINE

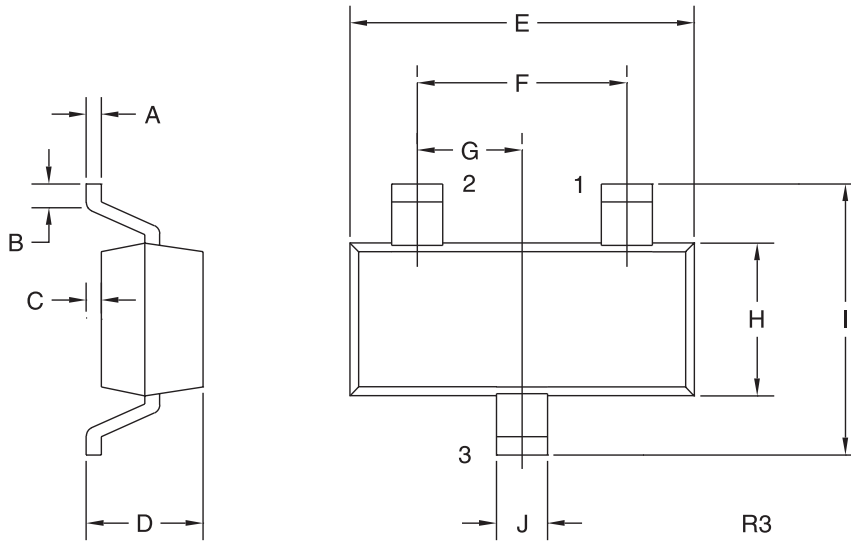

LEAD CODE:

- 1) BASE
- 2) EMITTER
- 3) COLLECTOR

MARKING CODE: C2N

SYMBOL	DIMENSIONS			
	INCHES		MILLIMETERS	
	MIN	MAX	MIN	MAX
A	0.003	0.007	0.08	0.18
B	0.006	-	0.15	-
C	-	0.005	-	0.13
D	0.035	0.043	0.89	1.09
E	0.110	0.120	2.80	3.05
F	0.075		1.90	
G	0.037		0.95	
H	0.047	0.055	1.19	1.40
I	0.083	0.098	2.10	2.49
J	0.014	0.020	0.35	0.50

SOT-23 (REV: R3)



LittleDiode supplies new, hard to find or obsolete electronic components and semiconductors all over the world.

With over two million different components listed you are sure to find the part you need.

Feel free to visit us today at our online store:

LittleDiode.com

Looking forward to providing you with the best possible service.