

CMPH81
SURFACE MOUNT
PNP SILICON RF TRANSISTOR

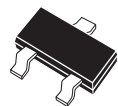

SOT-23 CASE

CentralTM

Semiconductor Corp.

DESCRIPTION:

The CENTRAL SEMICONDUCTOR CMPH81 type is a PNP Silicon RF Transistor, epoxy molded in a surface mount package, designed for general RF amplifier applications.

MARKING CODE: C3D

MAXIMUM RATINGS: ($T_A=25^{\circ}\text{C}$)

| | SYMBOL | | UNITS |
|--------------------------------|----------------|-------------|----------------------|
| Collector-Base Voltage | V_{CB0} | 20 | V |
| Collector-Emitter Voltage | V_{CEO} | 20 | V |
| Emitter-Base Voltage | V_{EBO} | 3.0 | V |
| Collector Current (Continuous) | I_C | 50 | mA |
| Power Dissipation | P_D^* | 225 | mW |
| Operating and Storage | | | |
| Junction Temperature | T_J, T_{stg} | -55 to +150 | $^{\circ}\text{C}$ |
| Thermal Resistance | θ_{JA} | 556 | $^{\circ}\text{C/W}$ |

ELECTRICAL CHARACTERISTICS: ($T_A=25^{\circ}\text{C}$ UNLESS OTHERWISE NOTED)

| SYMBOL | TEST CONDITIONS | MIN | MAX | UNITS |
|---------------|--|-----|------|-------|
| I_{CBO} | $V_{CB}=10\text{V}$ | | 100 | nA |
| I_{EBO} | $V_{EB}=2.0\text{V}$ | | 100 | nA |
| BV_{CBO} | $I_C=10\mu\text{A}$ | 20 | | V |
| BV_{CEO} | $I_C=1.0\text{mA}$ | 20 | | V |
| BV_{EBO} | $I_E=10\mu\text{A}$ | 3.0 | | V |
| $V_{CE(SAT)}$ | $I_C=5.0\text{mA}, I_B=500\mu\text{A}$ | | 0.5 | V |
| $V_{BE(ON)}$ | $V_{CE}=10\text{V}, I_C=5.0\text{mA}$ | | 0.9 | V |
| h_{FE} | $V_{CE}=10\text{V}, I_C=5.0\text{mA}$ | 60 | | |
| f_T | $V_{CE}=10\text{V}, I_C=5.0\text{mA}, f=100\text{MHz}$ | 600 | | MHz |
| C_{cb} | $V_{CB}=10\text{V}, I_E=0, f=1.0\text{MHz}$ | | 0.85 | pF |
| C_{ce} | $V_{CB}=10\text{V}, I_B=0, f=1.0\text{MHz}$ | | 0.65 | pF |

* FR-4 Epoxy PCB Substrate 1.6" x 1.6" x 0.06"

SOT-23 CASE- MECHANICAL OUTLINE

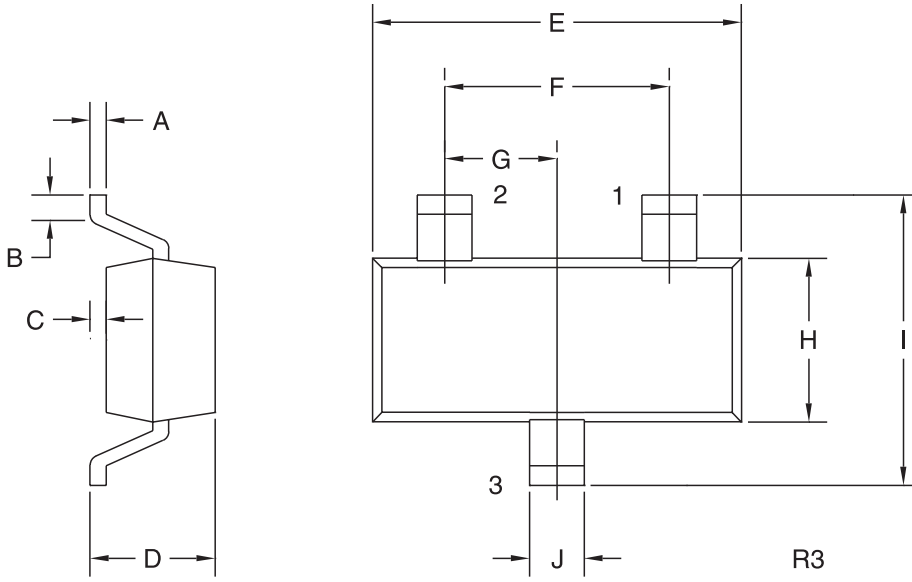

LEAD CODE:

- 1) BASE
- 2) EMITTER
- 3) COLLECTOR

MARKING CODE: C3D

| SYMBOL | DIMENSIONS | | | |
|--------|------------|-------|-------------|------|
| | INCHES | | MILLIMETERS | |
| | MIN | MAX | MIN | MAX |
| A | 0.003 | 0.007 | 0.08 | 0.18 |
| B | 0.006 | - | 0.15 | - |
| C | - | 0.005 | - | 0.13 |
| D | 0.035 | 0.043 | 0.89 | 1.09 |
| E | 0.110 | 0.120 | 2.80 | 3.05 |
| F | 0.075 | | 1.90 | |
| G | 0.037 | | 0.95 | |
| H | 0.047 | 0.055 | 1.19 | 1.40 |
| I | 0.083 | 0.098 | 2.10 | 2.49 |
| J | 0.014 | 0.020 | 0.35 | 0.50 |

SOT-23 (REV: R3)



LittleDiode supplies new, hard to find or obsolete electronic components and semiconductors all over the world.

With over two million different components listed you are sure to find the part you need.

Feel free to visit us today at our online store:

LittleDiode.com

Looking forward to providing you with the best possible service.