

CMST5086
CMST5087

**SURFACE MOUNT
SUPERmini™
PNP SILICON TRANSISTORS**

SUPERmini™



SOT-323 CASE

Central™
Semiconductor Corp.

DESCRIPTION:

The CENTRAL SEMICONDUCTOR CMST5086, CMST5087 types are PNP silicon transistors manufactured by the epitaxial planar process, epoxy molded in a SUPERmini™ surface mount package, designed for applications requiring high gain and low noise.

**MARKING CODES: CMST5086: 2PC
CMST5087: 2QC**

MAXIMUM RATINGS: ($T_A=25^\circ\text{C}$)

Collector-Base Voltage
Collector-Emitter Voltage
Emitter-Base Voltage
Collector Current
Power Dissipation
Operating and Storage
Junction Temperature
Thermal Resistance

SYMBOL		UNITS
V_{CBO}	50	V
V_{CEO}	50	V
V_{EBO}	3.0	V
I_C	50	mA
P_D	275	mW
T_J, T_{stg}	-65 to +150	$^\circ\text{C}$
θ_{JA}	455	$^\circ\text{C}/\text{W}$

ELECTRICAL CHARACTERISTICS ($T_A=25^\circ\text{C}$ unless otherwise noted)

SYMBOL	TEST CONDITIONS	CMST5086		CMST5087		UNITS
		MIN	MAX	MIN	MAX	
I_{CBO}	$V_{CB}=10\text{V}$		10		10	nA
I_{CBO}	$V_{CB}=35\text{V}$		50		50	nA
BV_{CBO}	$I_C=100\mu\text{A}$	50		50		V
BV_{CEO}	$I_C=1.0\text{mA}$	50		50		V
BV_{EBO}	$I_E=100\mu\text{A}$	3.0		3.0		V
$V_{CE(SAT)}$	$I_C=10\text{mA}, I_B=1.0\text{mA}$		0.30		0.30	V
$V_{BE(SAT)}$	$I_C=10\text{mA}, I_B=1.0\text{mA}$		0.85		0.85	V
h_{FE}	$V_{CE}=5.0\text{V}, I_C=0.1\text{mA}$	150	500	250	800	
h_{FE}	$V_{CE}=5.0\text{V}, I_C=1.0\text{mA}$	150		250		
h_{FE}	$V_{CE}=5.0\text{V}, I_C=10\text{mA}$	150		250		
f_T	$V_{CE}=5.0\text{V}, I_C=500\mu\text{A}, f=20\text{MHz}$	40		40		MHz
C_{ob}	$V_{CB}=5.0\text{V}, I_E=0, f=1.0\text{MHz}$		4.0		4.0	pF
h_{fe}	$V_{CE}=5.0\text{V}, I_C=1.0\text{mA}, f=1.0\text{kHz}$	150	600	250	900	
NF	$V_{CE}=5.0\text{V}, I_C=20\text{mA}, R_S=10\text{k}\Omega$ $f=10\text{Hz to }15.7\text{kHz}$		3.0		2.0	dB
NF	$V_{CE}=5.0\text{V}, I_C=100\mu\text{A}, R_S=3.0\text{k}\Omega$ $f=1.0\text{kHz}$		3.0		2.0	dB

R2 (4-January 2004)

**SURFACE MOUNT
SUPERminiTM
PNP SILICON TRANSISTORS**

SOT-323 CASE - MECHANICAL OUTLINE

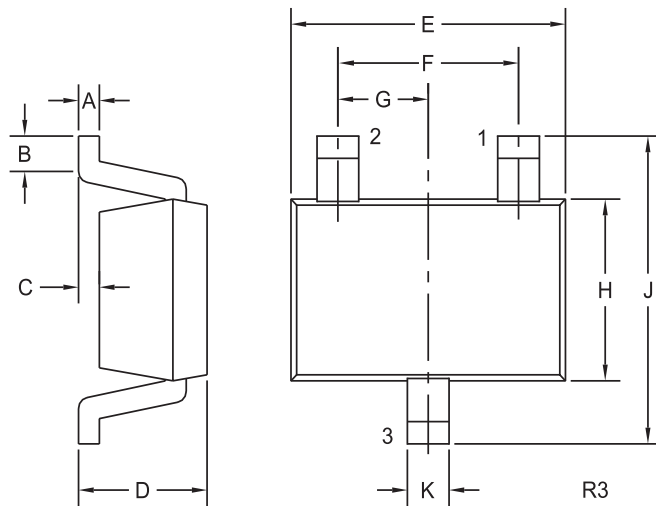

SYMBOL	INCHES		MILLIMETERS	
	MIN	MAX	MIN	MAX
A	0.002	0.008	0.05	0.20
B	0.004	-	0.10	-
C	-	0.004	-	0.10
D	0.031	0.043	0.80	1.10
E	0.071	0.087	1.80	2.20
F	0.051		1.30	
G	0.026		0.65	
H	0.045	0.053	1.15	1.35
J	0.079	0.087	2.00	2.20
K	0.008	0.016	0.20	0.40

SOT-323 (REV: R3)

**CMST5086
CMST5087**

LEAD CODE:

- 1) BASE
- 2) EMITTER
- 3) COLLECTOR

MARKING CODE:

CMST5086 - 2PC
CMST5087 - 2QC

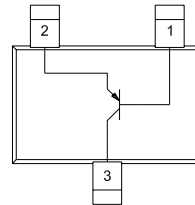



LittleDiode supplies new, hard to find or obsolete electronic components and semiconductors all over the world.

With over two million different components listed you are sure to find the part you need.

Feel free to visit us today at our online store:

LittleDiode.com

Looking forward to providing you with the best possible service.