

CMST5088
CMST5089

SUPERmini™
SURFACE MOUNT
NPN SILICON TRANSISTORS

SUPERmini™



SOT-323 CASE

Central™
Semiconductor Corp.

DESCRIPTION:

The CENTRAL SEMICONDUCTOR CMST5088, CMST5089 types are NPN silicon transistors manufactured by the epitaxial planar process, epoxy molded in a SUPERmini™ surface mount package, designed for applications requiring high gain and low noise. Marking Codes are 1QC, 1RC respectively.

MAXIMUM RATINGS: ($T_A=25^\circ\text{C}$)

	SYMBOL	CMST5088	CMST5089	UNITS
Collector-Base Voltage	V_{CBO}	35	30	V
Collector-Emitter Voltage	V_{CEO}	30	25	V
Emitter-Base Voltage	V_{EBO}	4.5		V
Collector Current	I_C	50		mA
Power Dissipation	P_D	250		mW
Operating and Storage				
Junction Temperature	T_J, T_{stg}	-65 to +150		$^\circ\text{C}$
Thermal Resistance	θ_{JA}	500		$^\circ\text{C/W}$

ELECTRICAL CHARACTERISTICS: ($T_A=25^\circ\text{C}$ unless otherwise noted)

SYMBOL	TEST CONDITIONS	CMST5088		CMST5089		UNITS
		MIN	MAX	MIN	MAX	
I_{CBO}	$V_{CB}=20\text{V}$		50			nA
I_{CBO}	$V_{CB}=15\text{V}$			50		nA
I_{EBO}	$V_{EB}=3.0\text{V}$		50			nA
I_{EBO}	$V_{EB}=4.5\text{V}$			100		nA
BV_{CBO}	$I_C=100\mu\text{A}$	35		30		V
BV_{CEO}	$I_C=1.0\text{mA}$	30		25		V
BV_{EBO}	$I_E=100\mu\text{A}$	4.5		4.5		V
$V_{CE(SAT)}$	$I_C=10\text{mA}, I_B=1.0\text{mA}$		0.5		0.5	V
$V_{BE(SAT)}$	$I_C=10\text{mA}, I_B=1.0\text{mA}$		0.8		0.8	V
h_{FE}	$V_{CE}=5.0\text{V}, I_C=0.1\text{mA}$	300	900	400	1200	
h_{FE}	$V_{CE}=5.0\text{V}, I_C=1.0\text{mA}$	350		450		
h_{FE}	$V_{CE}=5.0\text{V}, I_C=10\text{mA}$	300		400		
f_T	$V_{CE}=5.0\text{V}, I_C=500\mu\text{A}, f=20\text{MHz}$	50		50		MHz
C_{ob}	$V_{CB}=5.0\text{V}, I_E=0, f=1.0\text{MHz}$		4.0		4.0	pF
C_{ib}	$V_{BE}=0.5\text{V}, I_C=0, f=1.0\text{MHz}$		15		15	pF
h_{fe}	$V_{CE}=5.0\text{V}, I_C=1.0\text{mA}, f=1.0\text{kHz}$	350	1400	450	1800	
NF	$V_{CE}=5.0\text{V}, I_C=100\mu\text{A}, R_S=10\text{k}\Omega$ $f=10\text{Hz to } 15.7\text{kHz}$		3.0		2.0	dB

R1 (19-September 2001)

SUPERminiTM
SURFACE MOUNT
NPN SILICON TRANSISTORS

SOT-323 CASE - MECHANICAL OUTLINE

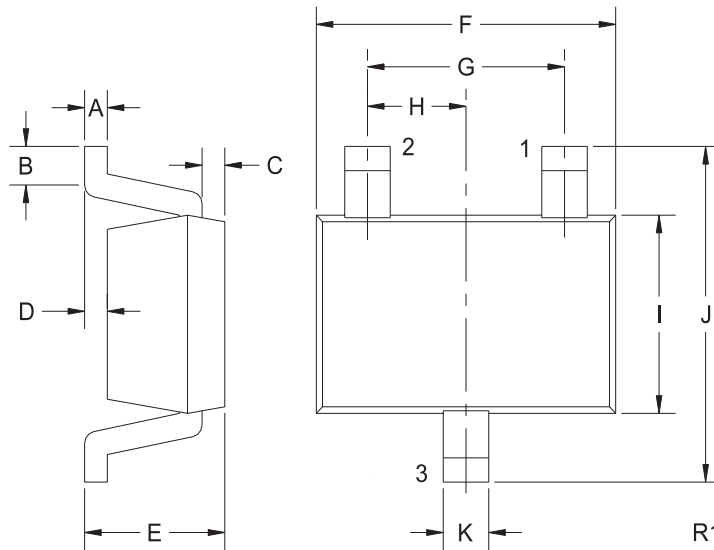

LEAD CODE:

- 1) BASE
- 2) EMITTER
- 3) COLLECTOR

MARKING CODE:
CMST5088 - 1QC
CMST5089 - 1RC

SYMBOL	INCHES		MILLIMETERS	
	MIN	MAX	MIN	MAX
A	0.004	0.008	0.10	0.20
B	0.004	-	0.10	-
C	0.004	0.008	0.10	0.20
D	-	0.004	-	0.10
E	0.031	0.043	0.80	1.10
F	0.071	0.087	1.80	2.20
G	0.051		1.30	
H	0.026		0.65	
I	0.045	0.053	1.15	1.35
J	0.079	0.087	2.00	2.20
K	0.008	0.016	0.20	0.40

SOT-323 (REV: R1)

R1 (19-September 2001)



LittleDiode supplies new, hard to find or obsolete electronic components and semiconductors all over the world.

With over two million different components listed you are sure to find the part you need.

Feel free to visit us today at our online store:

LittleDiode.com

Looking forward to providing you with the best possible service.