



# DATA SHEET

## GBJ4A~GBJ4K

**GLASS PASSIVATED SINGLE-PHASE BRIDGE RECTIFIER**

**VOLTAGE - 50 to 800 Volts CURRENT - 4.0 Amperes**



Recognized File #E228882

GBJ

Unit: inch ( mm )

### FEATURES

- Plastic material has Underwriters Laboratory Flammability Classification 94V-O
- Ideal for printed circuit board
- Reliable low cost construction utilizing molded plastic technique
- Surge overload rating: 150 Amperes peak
- High temperature soldering guaranteed:  
260°C/10 seconds/.375"(9.5mm) lead length at 5 lbs. (2.3kg) tension

### MECHANICAL DATA

Case: Reliable low cost construction utilizing molded plastic technique  
 Terminals: Leads solderable per MIL-STD-202, Method 208  
 Mounting position: Any  
 Mounting torque: 5 in. lb. Max.  
 Weight: 0.15 ounce, 4.0 grams

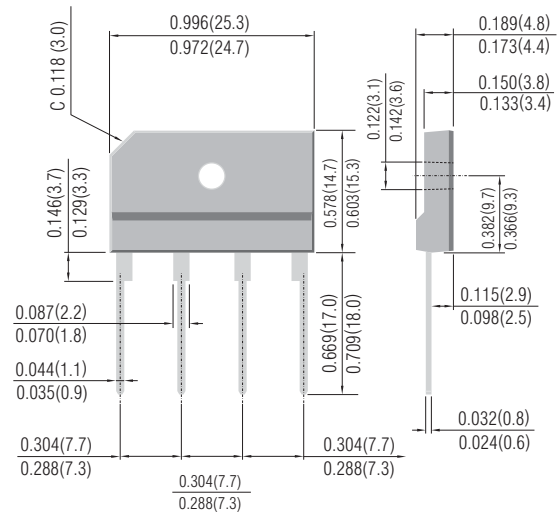

### MAXIMUM RATINGS AND ELECTRICAL CHARACTERISTICS

Rating at 25°C ambient temperature unless otherwise specified. Resistive or inductive load, 60Hz.  
 For Capacitive load derate current by 20%.

	GBJ4A	GBJ4B	GBJ4D	GBJ4G	GBJ4J	GBJ4K	UNIT
Maximum Recurrent Peak Reverse Voltage	50	100	200	400	600	800	V
Maximum RMS Input Voltage	35	70	140	280	420	560	V
Maximum DC Blocking Voltage	50	100	200	400	600	800	V
Maximum Average Forward $T_C=100^\circ\text{C}$ Rectified Output Current	4.0						A
$I^2t$ Rating for fusing ( $t < 8.3\text{ms}$ )	127						A <sup>2</sup> sec
Peak Forward Surge Current single sine-wave superimposed on rated load (JEDEC method)	150						Apk
Maximum Instantaneous Forward Voltage Drop per element at 2.0A	1.0						Vpk
Maximum Reverse Leakage at rated $T_A=25^\circ$ CDc Blocking Voltage per element $T_C=100^\circ\text{C}$	5 500						$\mu\text{A}$ $\mu\text{A}$
Typical Thermal Resistance per leg(Note 2) R $\theta$ JA	8.6						°C / W
Typical Thermal Resistance per leg(Note 3) R $\theta$ JC	3.1						°C / W
Operating and Storage Temperature Range, $T_J, T_{STG}$	-55 to +150						°C

**NOTES:**

1. Recommended mounting position is to bolt down on heatsink with silicone thermal compound for maximum heat transfer with #6 screw.
2. Units Mounted in free air, no heatsink, P.C.B at 0.375"(9.5mm) lead length with 0.5 x 0.5"(12 x 12mm)copper pads.
3. Units Mounted on a 2.6 x 1.4" x 0.06" thick ( 6.5 x 3.5 x 0.15cm) AL plate.



**RATING AND CHARACTERISTIC CURVES**

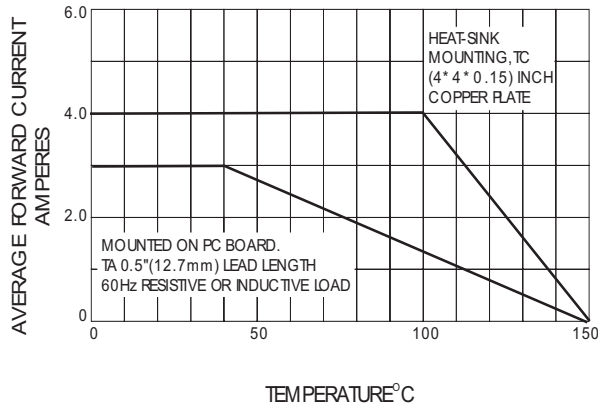

Fig. 1- DERATING CURVE FOR OUTPUT RECTIFIED CURRENT

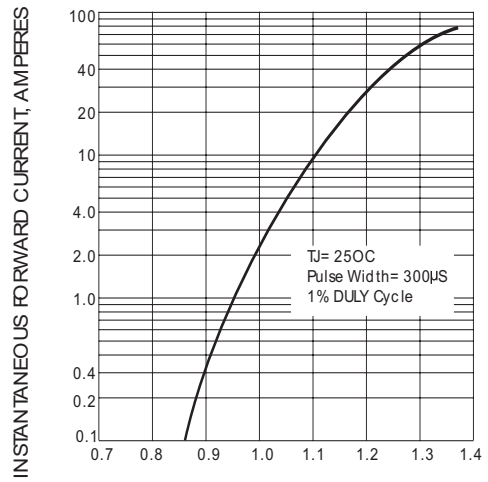

Fig. 2- TYPICAL INSTANTANEOUS FORWARD CHARACTERISTICS PER ELEMENT

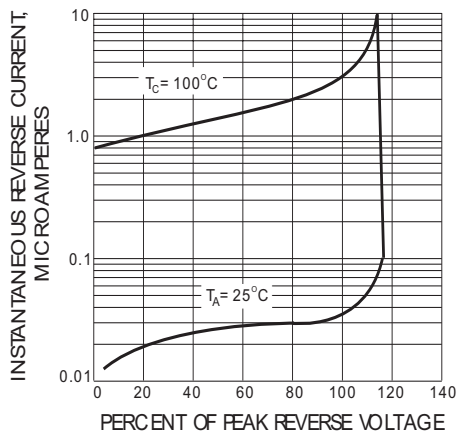

Fig. 3- TYPICAL PEAK REVERSE CHARACTERISTICS

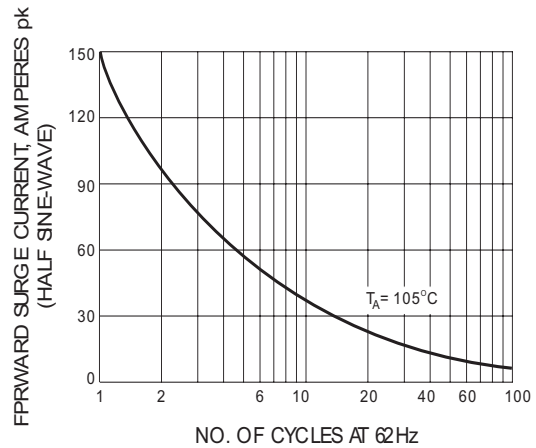

Fig. 4- MAXIMUM NON-REPETITIVE PEAK FORWARD SURGE CURRENT

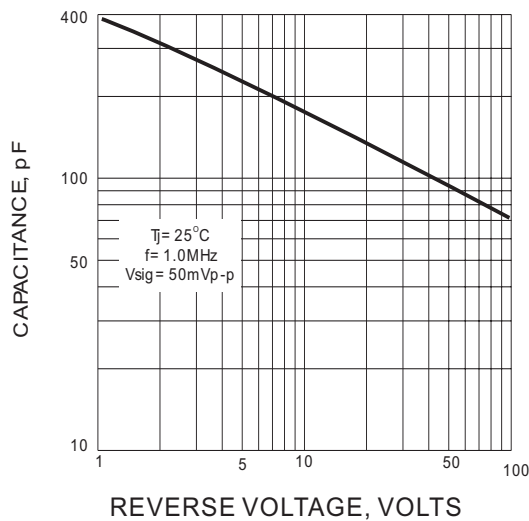

Fig.5- TYPICAL JUNCTION CAPACITANCE PER ELEMENT



LittleDiode supplies new, hard to find or obsolete electronic components and semiconductors all over the world.

With over two million different components listed you are sure to find the part you need.

Feel free to visit us today at our online store:

[LittleDiode.com](http://LittleDiode.com)

Looking forward to providing you with the best possible service.