

## MEDIUM-POWER PNP SILICON TRANSISTORS

..designed for driver circuits, switching and amplifier applications.

### FEATURES:

- \* Low Collector-Emitter Saturation Voltage  
 $V_{CE(sat)} = 0.6 \text{ V (Max.) @ } I_C = 1.0 \text{ A}$
- \* Excellent Safe Operating Area
- \* Gain Specified to  $I_C = 1.0 \text{ Amp.}$
- \* 2N4900 Complementary to NPN 2N4912

### MAXIMUM RATINGS

Characteristic	Symbol	2N4898	2N4899	2N4900	Unit
Collector-Emitter Voltage	$V_{CEO}$	40	60	80	V
Collector-Base Voltage	$V_{CBO}$	40	60	80	V
Emitter-Base Voltage	$V_{EBO}$	5.0			V
Collector Current-Continuous -Peak	$I_C$ $I_{CM}$	1.0 4.0			A
Base Current	$I_B$	1.0			A
Total Power Dissipation @ $T_C = 25^\circ\text{C}$ Derate above $25^\circ\text{C}$	$P_D$	25 0.143			W W/ $^\circ\text{C}$
Operating and Storage Junction Temperature Range	$T_J, T_{STG}$	- 65 to +200			$^\circ\text{C}$

### THERMAL CHARACTERISTICS

Characteristic	Symbol	Max	Unit
Thermal Resistance Junction to Case	$R_{\theta jc}$	7.0	$^\circ\text{C/W}$

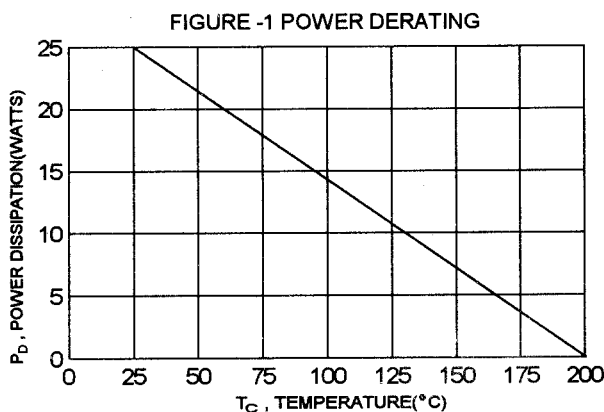

**PNP**  
**2N4898**  
**2N4899**  
**2N4900**

**1 AMPERE**  
**PNP SILICON**  
**POWER TRANSISTOR**  
**40- 80 VOLTS**  
**25 WATTS**

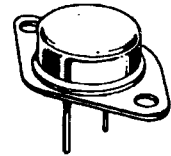

**TO-66**

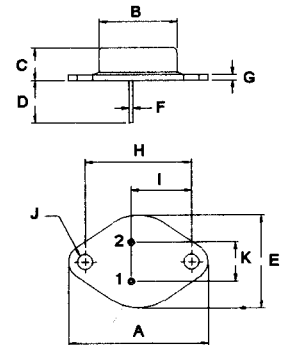

PIN 1.BASE  
 2.EMITTER  
 COLLECTOR(CASE)

DIM	MILLIMETERS	
	MIN	MAX
A	30.60	32.52
B	13.85	14.16
C	6.54	7.22
D	9.50	10.50
E	17.26	18.46
F	0.76	0.92
G	1.38	1.65
H	24.16	24.78
I	13.84	15.60
J	3.32	3.92
K	4.86	5.34

ELECTRICAL CHARACTERISTICS (  $T_c = 25^\circ\text{C}$  unless otherwise noted )

Characteristic	Symbol	Min	Max	Unit
<b>OFF CHARACTERISTICS</b>				
Collector - Emitter Sustaining Voltage (1) ( $I_c = 100\text{ mA}$ , $I_B = 0$ )	$V_{CE(sus)}$	40 60 80		V
Collector Cutoff Current ( $V_{CE} = 20\text{ V}$ , $I_B = 0$ ) ( $V_{CE} = 30\text{ V}$ , $I_B = 0$ ) ( $V_{CE} = 40\text{ V}$ , $I_B = 0$ )	$I_{CEO}$		0.5 0.5 0.5	mA
Collector Cutoff Current ( $V_{CE} = \text{Rate } V_{CEO}$ , $V_{BE(off)} = 1.5\text{ V}$ ) ( $V_{CE} = \text{Rate } V_{CEO}$ , $V_{BE(off)} = 1.5\text{ V}$ , $T_c = 150^\circ\text{C}$ )	$I_{CEX}$		0.1 1.0	mA
Collector Cutoff Current ( $V_{CB} = \text{Rate } V_{CBO}$ , $I_E = 0$ )	$I_{CBO}$		0.1	mA
Emitter Cutoff Current ( $V_{EB} = 5.0\text{ V}$ , $I_C = 0$ )	$I_{EBO}$		1.0	mA

## ON CHARACTERISTICS (1)

DC Current Gain ( $I_c = 50\text{ mA}$ , $V_{CE} = 1.0\text{ V}$ ) ( $I_c = 500\text{ mA}$ , $V_{CE} = 1.0\text{ V}$ ) ( $I_c = 1.0\text{ A}$ , $V_{CE} = 1.0\text{ V}$ )	$h_{FE}$	40 20 10	100	
Collector-Emitter Saturation Voltage ( $I_c = 1.0\text{ A}$ , $I_B = 0.1\text{ A}$ )	$V_{CE(sat)}$		0.6	V
Base-Emitter Saturation Voltage ( $I_c = 1.0\text{ A}$ , $I_B = 0.1\text{ A}$ )	$V_{BE(sat)}$		1.3	V
Base-Emitter On Voltage ( $I_c = 1.0\text{ A}$ , $V_{CE} = 1.0\text{ V}$ )	$V_{BE(on)}$		1.3	V

## DYNAMIC CHARACTERISTICS

Current Gain - Bandwidth Product (2) ( $I_c = 250\text{ mA}$ , $V_{CE} = 10\text{ V}$ , $f = 1.0\text{ MHz}$ )	$f_T$	3.0		
Output Capacitance ( $V_{CB} = 10\text{ V}$ , $I_E = 0$ , $f = 100\text{ KHz}$ )	$C_{ob}$		100	pF
Small-Signal Current Gain ( $I_c = 250\text{ mA}$ , $V_{CE} = 10\text{ V}$ , $f = 1.0\text{ KHz}$ )	$h_{fe}$	25		

(1) Pulse Test: Pulse width = 300 us , Duty Cycle  $\leq 2.0\%$ (2)  $f_T = |h_{fe}| \cdot f_{test}$

FIGURE 2 - SWITCHING TIME EQUIVALENT CIRCUIT

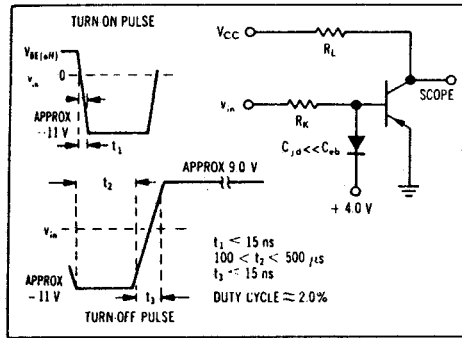

FIG-3 TURN-ON TIME

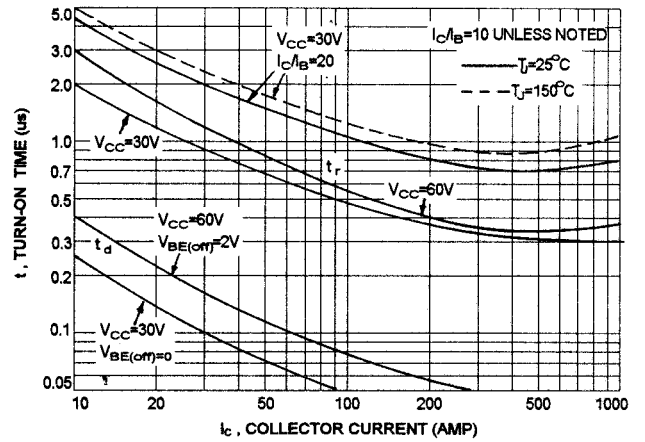

FIG-4 STORAGE TIME

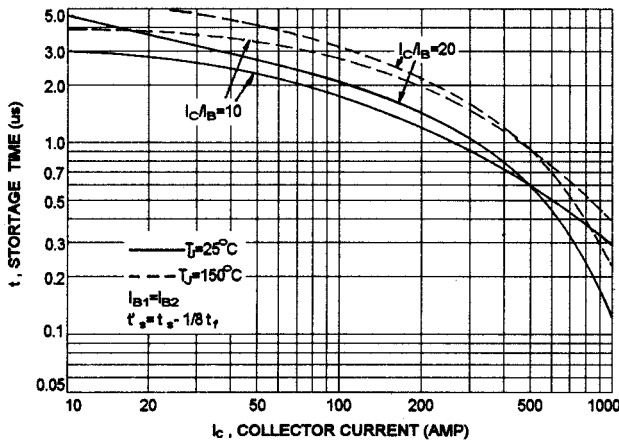

FIG-5 FALL TIME

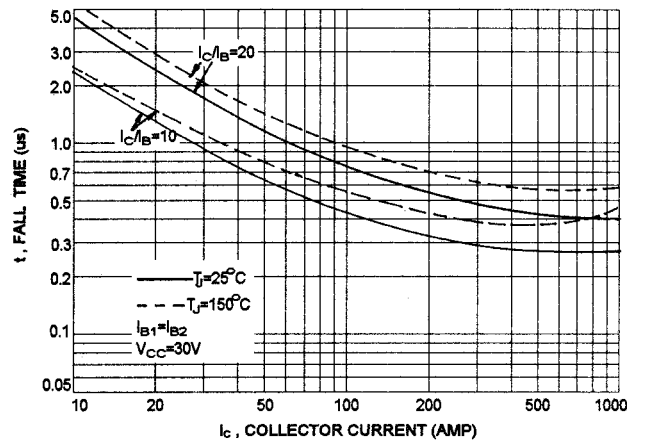
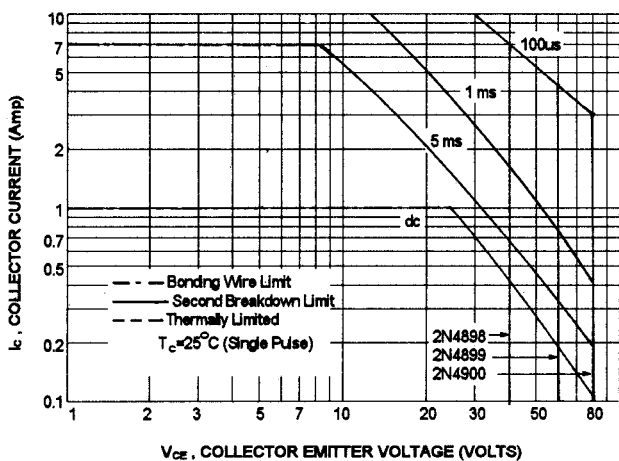

FIG-6 ACTIVE REGION SAFE OPERATING AREA



There are two limitation on the power handling ability of a transistor: average junction temperature and second breakdown safe operating area curves indicate  $I_c$ - $V_{CE}$  limits of the transistor that must be observed for reliable operation i.e., the transistor must not be subjected to greater dissipation than curves indicate.

The data of FIG-6 is base on  $T_{J(PK)} = 200^\circ\text{C}$ ;  $T_c$  is variable depending on power level. second breakdown pulse limits are valid for duty cycles to 10% provided  $T_{J(PK)} < 200^\circ\text{C}$ . At high case temperatures, thermal limitation will reduce the power that can be handled to values less than the limitations imposed by second breakdown.

FIG-7 COLLECTOR SATURATION REGION

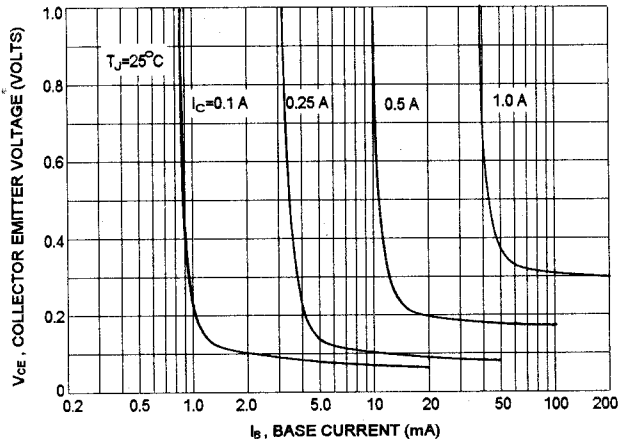

FIG-8 DC CURRENT GAIN

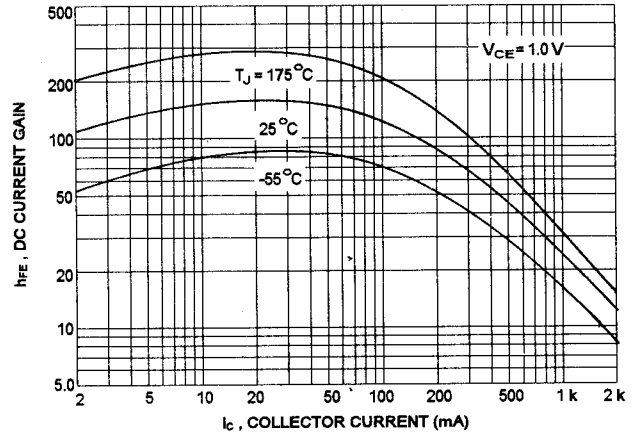

FIG-9 "ON" VOLTAGE

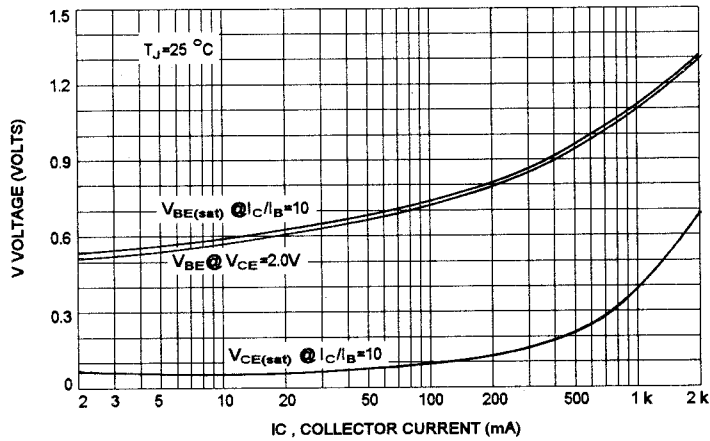
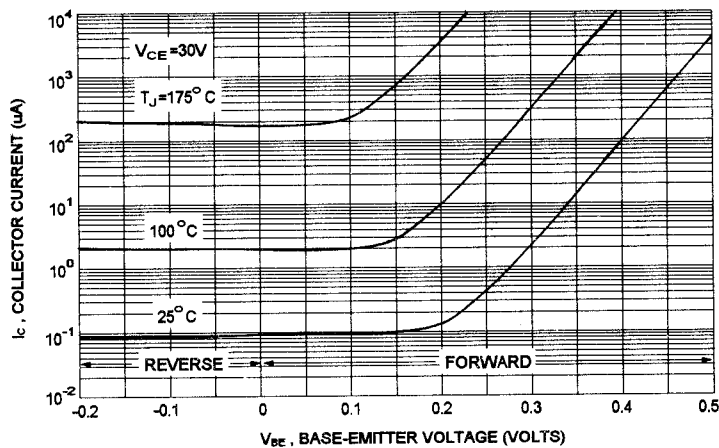

FIG-10 COLLECTOR CUT-OFF REGION





LittleDiode supplies new, hard to find or obsolete electronic components and semiconductors all over the world.

With over two million different components listed you are sure to find the part you need.

Feel free to visit us today at our online store:

[LittleDiode.com](http://LittleDiode.com)

Looking forward to providing you with the best possible service.