

AVAILABLE THROUGH DISTRIBUTION

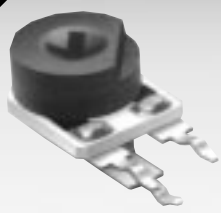

**BOURNS®**

### Features

- 9mm Round / Single-Turn / Cermet Industrial / Open Frame
- Both sides adjust
- Cross slot and hexagon adjustment designs
- Horizontal and vertical mounting styles

- Dust resistant/splash resistant covers
- PC board stand-offs and retention feature

## 3309 - 9mm Round Trimming Potentiometer

### Electrical Characteristics

Standard Resistance Range .....100 to 2 megohms  
 (see standard resistance table)  
 Resistance Tolerance .....±25% std.  
 Absolute Minimum Resistance .....2% max. (≤2K = 30 ohms)  
 Contact Resistance Variation ...3% max.  
 Resolution.....Infinite  
 Adjustment Angle .....235° nom.

### Environmental Characteristics

Power Rating (250 volts max.)  
 70°C .....0.5 watt  
 Temperature Range .....-25°C to +100°C  
 Temperature Coefficient .....±250ppm/°C  
 Load Life .....1,000 hours 0.5 watt  
 @ 70°C (5% ΔTR)

### Physical Characteristics

Mechanical Angle.....260°±20°  
 Torque (Operating).....5 oz-in. max.  
 Stop Strength.....11.0 oz -in. min.  
 Terminals .....Solderable pins  
 Marking .....Manufacturer's trademark, resistance code  
 Standard Packaging ....200 pcs. per bag  
 Adjustment Tool .....H-90  
 Aqueous cleaning not recommended

### How To Order

**3309 W - 2 - 103**

Model \_\_\_\_\_  
 Pin Style \_\_\_\_\_  
 Rotor Style \_\_\_\_\_  
 -2 = Cross Slot/Single Slot Rear Adjust  
 -3 = 2mm Hex Thru Hole  
 Resistance Code \_\_\_\_\_

### Top/Bottom Adjust Common Dimensions 3309P

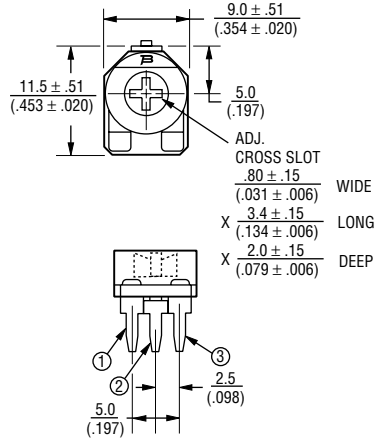

### 3309P-3 Both Sides Adjust Hex

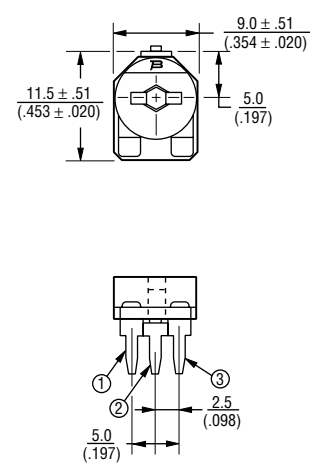

### 3309P-1 Top Adjust

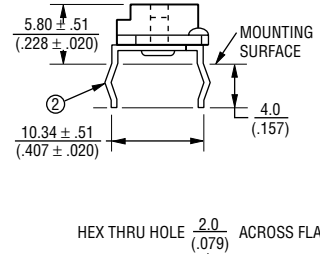
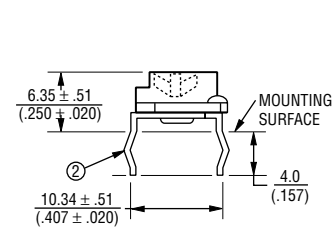

### 3309P-2 Both Sides Adjust/Cross Slot

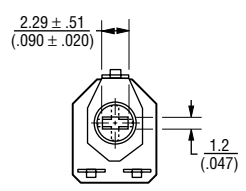
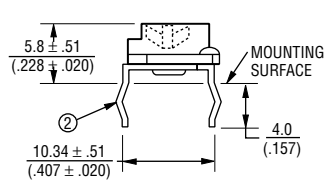

### SUGGESTED PWB LAYOUT - 3309P

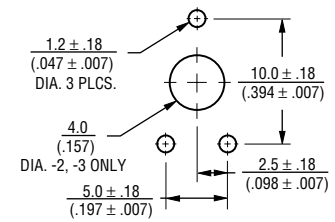

TOLERANCES: ± 0.25 (.010) EXCEPT WHERE NOTED

DIMENSIONS ARE:  $\frac{\text{METRIC}}{\text{(INCHES)}}$

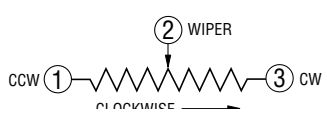

# 3309 - 9mm Round Trimming Potentiometer

**BOURNS**<sup>®</sup>

## Side Adjust Common Dimensions 3309W

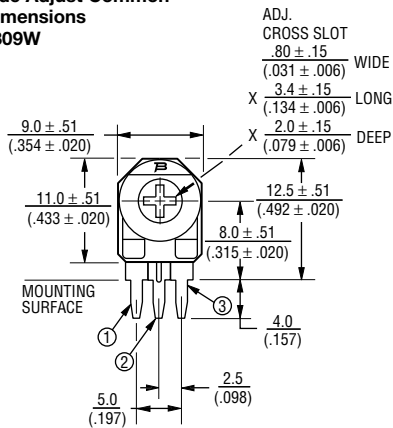

## 3309W-3 Both Sides Adjust Hex

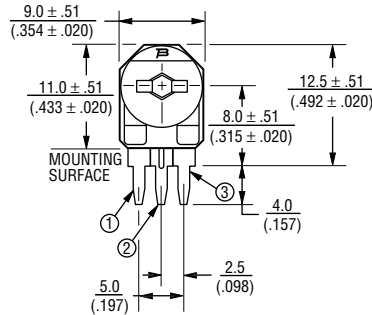

## 3309W-1 Single Side (Front) Adjust

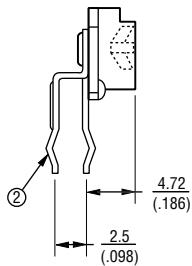

## 3309W-2 Both Sides Adjust - Cross Slot

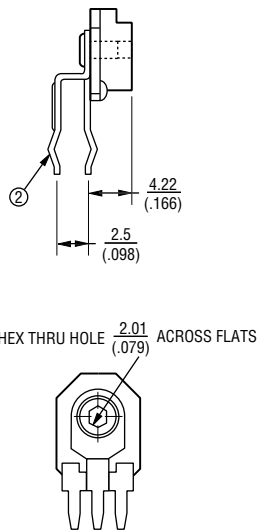
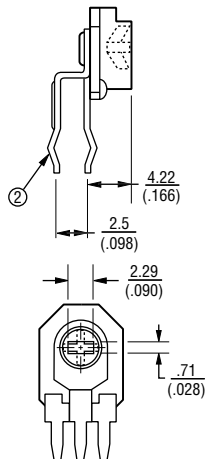

## Standard Resistance Table

Resistance (Ohms)	Resistance Code
100	101
200	201
500	501
<b>1,000</b>	<b>102</b>
<b>2,000</b>	<b>202</b>
<b>5,000</b>	<b>502</b>
<b>10,000</b>	<b>103</b>
<b>20,000</b>	<b>203</b>
<b>25,000</b>	<b>253</b>
<b>50,000</b>	<b>503</b>
<b>100,000</b>	<b>104</b>
200,000	204
250,000	254
500,000	504
1,000,000	105
2,000,000	205

Popular values listed in boldface. Special resistances available.

SHADED AREA NOT TYPICALLY STOCKED BY DISTRIBUTORS AND NOT RECOMMENDED FOR NEW DESIGNS.

## SUGGESTED PWB LAYOUT - 3309W

