

SC series
Standard product

SA series
Large capacitance miniaturized

SL series
5mm in height products

SH series
Long Life product

SG series
Specially designed for audio

SS series
Miniaturized products

SP series
Large Capacitance Low ESR

SM series
Horizontal SMD

SN series
Horizontal Miniaturized SMD

NewSV series
New Vertical SMD

SG Series

Specially designed for audio



- This is optimum for digital audio and Hi-Fi VCR. Since **OS-CON** has solid electrolyte and resin-sealed structure, it doesn't expose the phenomenon of element vibration.
- Adopted OFC (Oxygen Free Copper) into the lead wires for improvement of tone quality.

Sleeve color : Purple
 Marking : Polarity(Cathode),
 (Gold) Rated voltage,
 Capacitance
SANYO, OS-CON, Lot. No.
 Max. operating temp. (105°C)

Specifications

Items		Characteristics		
1	Operating temperature range	- 55degrees C ~ +105degrees C		
2	Capacitance tolerance(120Hz)	M(±20%)		
3	Tangent of loss angle(120Hz)	Value in Table 5 or less		
4	Leakage current(uA/2min.)(or less) ※ 2	0.02CV(0.04CV for G,H)		
5	ESR(100k ~ 300kHz)	Value in Table 5 or less		
6	Temperature characteristics Impedance ratio at 100kHz	-55degrees C	Z/Z 20degrees C	1.0 ~ 1.25
		+105degrees C	Z/Z 20degrees C	0.75 ~ 1.0
7	High-temperature load 105degrees C, 2000Hrs.(□12.5 1000Hrs.) Rated voltage applied (25WV• 20V applied) ※ 1	ΔC/C	Within ±20%	
		Tangent of loss angle	1.5 times of Item 3 or less	
		Leakage current	Item 4 or less	
8	Moisture resistance (60degrees C,90 ~ 95%RH,1000Hrs.no voltage)	ΔC/C	Within ±10%	
		Tangent of loss angle	1.5 times of Item 3 or less	
		Leakage current	Item 4 or less	
9	Reverse voltage guarantee	Temporary:less than 20% of the rated voltage, Continuous:less than 10% of the rated voltage.		

※ 1	To use an OS-CON when the operating temperature exceeds 85degrees C on a component with a rated voltage of 25V, reduce the voltage by 0.25V for every degree(1degrees C) relative to the value at 85degrees C(25V).
※ 2	If any doubt arises, measure the current after applying voltage(voltage treatment) for 30 minutes at 105degrees C. The rated voltage should be applied for 6.3 to 16,20,30WV, while a temperature reduction voltage should be applied for 25WV.

Dimensions

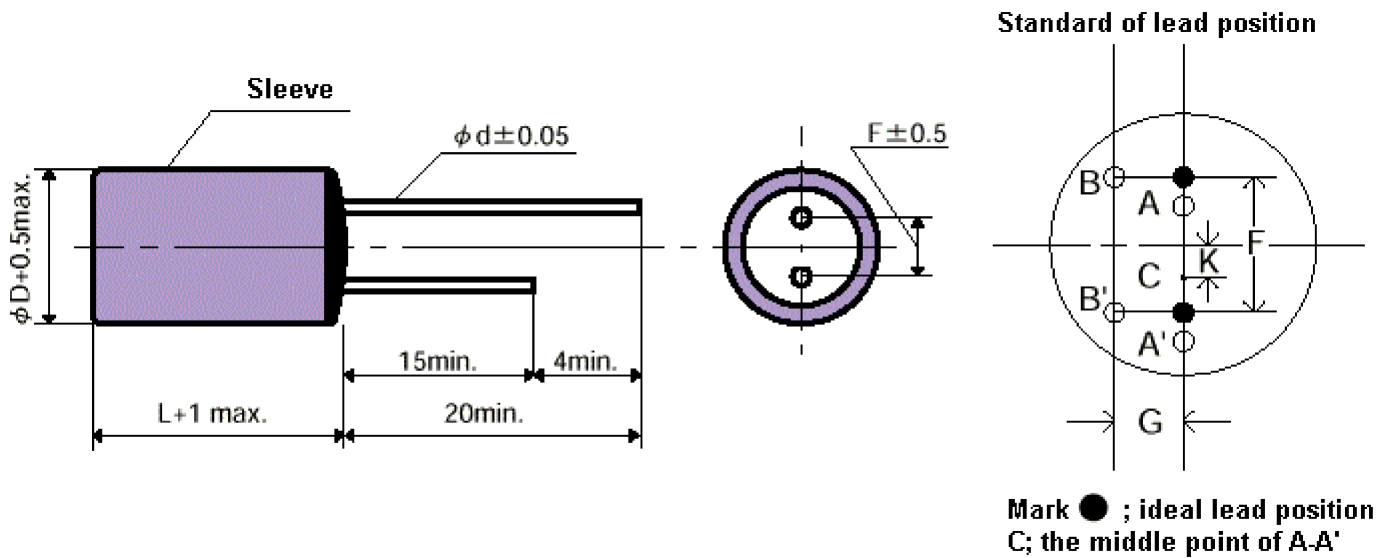

Size Code	C	D	E	F	G	H
$\phi D * L (\text{mm})$	6.3*6.8	6.3*9.8	8*10.5	10*10.5	12.5*22	16*25
F(mm)	2.5 ± 0.5	2.5 ± 0.5	3.5 ± 0.5	5.0 ± 0.5	5.0 ± 1.0	7.5 ± 1.0
$\phi d (\text{mm})$	0.45	0.60	0.60	0.60	0.80	0.80
G max.(mm)	0.5	0.5	0.8	0.8	0.8	0.8
K max.(mm)	0.5	0.5	0.8	0.8	0.8	0.8

Size List

WV(SV)	6.3WV (7.2SV)	10WV (11.5SV)	16WV (18.4SV)	20WV (23SV)	25WV (25SV)
4.7uF	-	-	-	-	C
6.8uF	-	-	-	-	C
10uF	-	-	C	-	C
15uF	-	-	-	C	D
22uF	-	-	-	C	-
33uF	-	-	C	D	-
47uF	C	-	D	E	-
68uF	-	D	-	E	-
100uF	-	-	E	F	-
150uF	E	-	F	-	-
220uF	-	F	-	-	-
330uF	F	-	-	-	-
470uF	-	-	G	-	-
1000uF	-	-	H	-	-
2200uF	H	-	-	-	-

Table 5 SG Series Characteristics List

Temperature coefficient for ripple current

Ambient Temp.	~ +45degrees C	+65degrees C	+85degrees C	+95degrees C	+105degrees C
Coefficient	1.0	0.85	0.7	0.4	0.25

Size Code	Part Number ※1	Rated Voltage (V)	Nominal Capacitance (uF)	ESR 100kHz ~ 300kHz (mohm)(max.)	Maximum allowable ripple current (mArms) ※2	Tangent of loss angle (max.)	Leakage current(uA) (max.) ※3
C	25SG4R7M	25	4.7	100	1130	0.05	2.35
	25SG6R8M	25	6.8	100	1140	0.05	3.40
	25SG10M	25	10	90	1150	0.05	5.00
	20SG15M	20	15	90	1200	0.06	6.00
	20SG22M	20	22	70	1300	0.06	8.80
	16SG10M	16	10	90	1150	0.06	3.20
	16SG33M	16	33	70	1370	0.06	10.56
	6SG47M	6.3	47	60	1430	0.07	5.92
D	25SG15M	25	15	70	1650	0.05	7.50
	20SG33M	20	33	70	1710	0.06	13.20
	16SG47M	16	47	60	1830	0.06	15.04
	10SG68M	10	68	50	2000	0.07	13.60
E	20SG47M	20	47	40	2450	0.06	18.80
	20SG68M	20	68	36	2600	0.06	27.20
	16SG100M	16	100	30	2740	0.06	32.00
	6SG150M	6.3	150	30	2780	0.07	18.90
F	20SG100M	20	100	30	3210	0.06	40.00
	16SG150M	16	150	28	3260	0.06	48.00
	10SG220M	10	220	27	3370	0.07	44.00
	6SG330M	6.3	330	25	3500	0.07	41.58
G	16SG470M	16	470	20	6080	0.08	300.80
H	16SG1000M	16	1000	15	9750	0.09	640.00
	6SG2200M	6.3	2200	15	9750	0.13	554.40

※1	Capacitance tolerance:M; ± 20%
※2	100kHz, +45degrees C
※3	After 2 minutes