

Transformers

Pulse Transformers

Pin Terminal

KP Series KP-37, -40 Types

KP-37 TYPE

CHARACTERISTICS

Insulation resistance	100M Ω min.[DC.100V]	
Withstand voltage Edc	100V	
Maximum rated current	50mA	
Temperature range	Operating	0 to +70°C
	Storage	-40 to +100°C

SHAPES AND DIMENSIONS

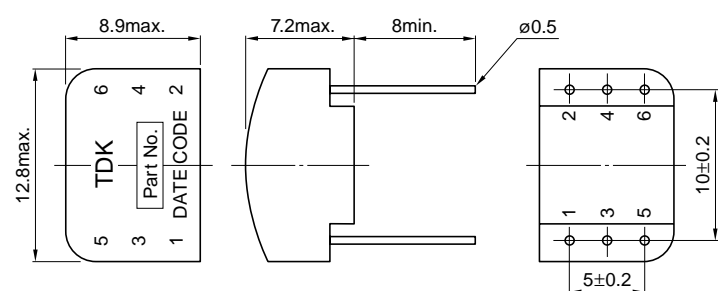

Weight: 1.6g typ.

Dimensions in mm

WINDING FORM AND PIN NUMBERINGS

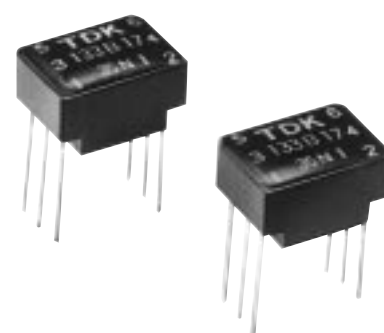
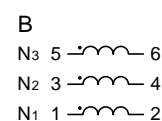

ELECTRICAL CHARACTERISTICS

Part No.	Turns ratio N ₁ :N ₂ :N ₃	Inductance N ₁ (μ H)min.	Leakage inductance N ₃ shorted (μ H)max.	Inter-winding capacitance N ₁ to N ₂ (pF)max.	DC resistance(Ω)max.			ET constant (V- μ s) min.
					N ₁	N ₂	N ₃	
113B*11	1 : 1 : 1	50	0.4	8	0.5	0.5	0.5	4
123B11	1 : 1 : 2	50	0.4	8	0.5	0.5	0.6	4
123B12	1 : 2 : 2	50	0.4	15	0.5	0.6	0.6	4
133B11	1 : 1 : 3	50	0.4	8	0.5	0.5	0.7	4
133B12	1 : 3 : 3	50	0.4	20	0.5	0.7	0.7	4
113B12	1 : 1 : 1	100	0.4	10	0.5	0.5	0.5	6
123B13	1 : 1 : 2	100	0.4	12	0.5	0.5	0.7	6
123B14	1 : 2 : 2	100	0.4	18	0.5	0.7	0.7	6
133B13	1 : 1 : 3	100	0.4	12	0.5	0.5	0.9	6
133B14	1 : 3 : 3	100	0.4	30	0.5	0.9	0.9	6
113B13	1 : 1 : 1	500	0.5	21	0.7	0.7	0.7	14
123B15	1 : 1 : 2	500	0.5	21	0.7	0.7	1.2	14
123B16	1 : 2 : 2	500	0.5	50	0.7	1.2	1.2	14
133B15	1 : 1 : 3	500	0.5	23	0.7	0.7	1.5	14
133B16	1 : 3 : 3	500	0.5	70	0.7	1.5	1.5	14
113B14	1 : 1 : 1	1000	0.7	30	0.9	0.9	0.9	20
123B17	1 : 1 : 2	1000	0.7	30	0.9	0.9	1.5	20
123B18	1 : 2 : 2	1000	0.7	70	0.9	1.5	1.5	20
133B17	1 : 1 : 3	1000	1	30	0.9	0.9	2.1	20
133B18	1 : 3 : 3	1000	1	100	0.9	2.1	2.1	20

* Refer to Winding form and pin numberings.

Transformers

Pulse Transformers

Pin Terminal

KP Series KP-37, -40 Types

KP-40 TYPE

CHARACTERISTICS

Insulation resistance		100M Ω min.[DC.100V]
Withstand voltage Edc		100V
Maximum rated current		50mA
Temperature range	Operating	0 to +70°C
	Storage	-40 to +100°C

SHAPES AND DIMENSIONS

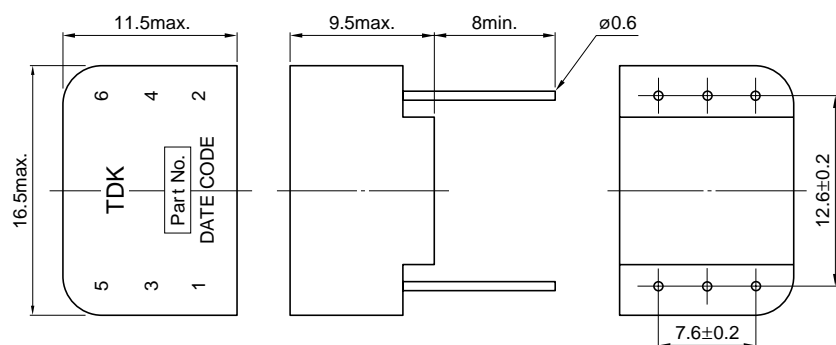

WINDING FORM AND PIN NUMBERINGS

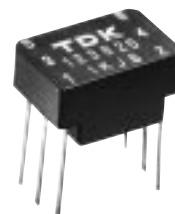
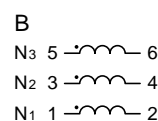

Weight: 2.8g typ.

Dimensions in mm

ELECTRICAL CHARACTERISTICS

Part No.	Turns ratio N ₁ :N ₂ :N ₃	Inductance N ₁ (μ H)min.	Leakage inductance N ₃ shorted (μ H)max.	Inter-winding capacitance N ₁ to N ₂ (pF)max.	DC resistance(Ω)max.			ET constant (V \cdot μ s) min.
					N ₁	N ₂	N ₃	
113B*15	1 : 1 : 1	100	0.5	15	0.6	0.6	0.6	7
123B19	1 : 1 : 2	100	0.5	15	0.6	0.6	0.85	7
123B20	1 : 2 : 2	100	0.5	30	0.6	0.85	0.85	7
133B19	1 : 1 : 3	100	0.5	15	0.6	0.6	1.2	7
133B20	1 : 3 : 3	100	0.5	100	0.6	1.2	1.2	7
113B16	1 : 1 : 1	500	1	60	0.85	0.85	0.85	17
123B21	1 : 1 : 2	500	1	60	0.85	0.85	1.5	17
123B22	1 : 2 : 2	500	1	80	0.85	1.5	1.5	17
133B21	1 : 1 : 3	500	1	70	0.85	0.85	2.5	17
133B22	1 : 3 : 3	500	1	110	0.85	2.5	2.5	17
113B17	1 : 1 : 1	1000	1.5	70	1.5	1.5	1.5	21
123B23	1 : 1 : 2	1000	1.5	70	1.5	1.5	3	21
123B24	1 : 2 : 2	1000	1.5	120	1.5	3	3	21
133B23	1 : 1 : 3	1000	1.5	70	1.5	1.5	4.4	21
133B24	1 : 3 : 3	1000	1.5	150	1.5	4.4	4.4	21

* Refer to Winding form and pin numberings.