

## MB-EXR Series

Super Low ESR at high frequency



MV-EXR series is an aluminum electrolytic capacitors with hybrid electrolyte of radial lead type. Solvent proof (within 5 minutes).

### Specifications

Items	Specifications		
Rated voltage (V)	4	6.3	10
Surge voltage (V)	4.6	7.2	11.5
Operating temperature range (°C)	-55 to +105		
Capacitance tolerance (%)	±20		(120Hz)
Tangent of loss angle (tanδ) (MAX.) (120Hz)	0.24	0.22	0.20
Leakage current (L.C.) (μA/after 2min.) (MAX.)	0.1CV		
Temperature characteristics Impedance ratio (120Hz)	Z <sub>-55°C</sub> /Z <sub>20°C</sub>	1~2.5	
	Z <sub>105°C</sub> /Z <sub>20°C</sub>	0.6~1.0	
High-temperature load rated voltage applied.	Test	105°C 2000hrs	
	ΔC/C	Within ± 25% of the initial value	
	tan δ	≤ Twice the initial standard	
	L.C.	≤ The initial standard	
Other characteristics	Conform to IEC 60384-4		

### Dimensions

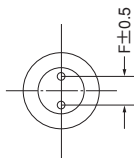
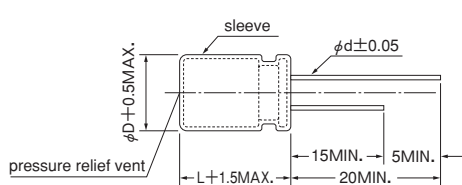

(Unit : mm)

φ D	8	10
F	3.5	5.0
φ d	0.6	0.6

### Size List : φ D × L (mm)

ESR [mΩ MAX. at 100kHz, 20°C]

Maximum permissible ripple current [mA r.m.s. at 100kHz, 105°C]

μF	V	4			6.3			10		
		Case size (φD×L)	ESR	Ripple current	Case size (φD×L)	ESR	Ripple current	Case size (φD×L)	ESR	Ripple current
330							8×11.5	18	1450	
390					8×11.5	16	1660			
560		8×11.5	14	1780						
680							10×12.5	14	2150	
820					10×12.5	13	2245			
1000		10×12.5	12	2340						

Model No.

