

Symmetrical type Silicon Varistors

V _F (V)	I _F (mA)	Part Number	I _F (μA) max	V _F (V)	I _{FSM} (A)	T _J (°C)	T _{stg} (°C)	R _{th(j-ℓ)} (°C/W)	Mass (g)	Fig. No.	Page where characteristic curve is shown
					50Hz Half-cycle Sinewave Single Shot						
1.5 max	1000	VR-60SS	20	0.2	15	-40 to +100		20	0.3	1	106
2.3±0.25	1	VR-61SS			7.5	-40 to +100		20	0.3		
2.75±0.25	10										
3.1±0.25	70										
4.0 max	100	SV-2SS	50	1.2		-40 to +100		20	0.3		
2.0 max	100	SV-3SS	50	0.6		-40 to +100		20	0.3		
1.8±0.2	1	SV-4SS	50	0.9		-40 to +100		20	0.3		
2.15±0.2	10										
2.4±0.25	30										

External Dimensions Flammability: UL94V-0 or Equivalent (Unit: mm)

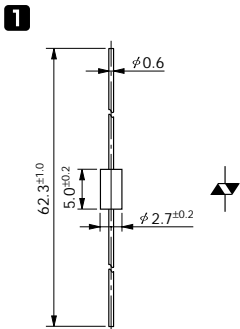

Part Number	VR-60SS	VR-61SS	SV-2SS	SV-3SS	SV-4SS
Color indication					
Internal junction					

Characteristic Curves Silicon Varistors

SV-2SS, 3SS, 4SS

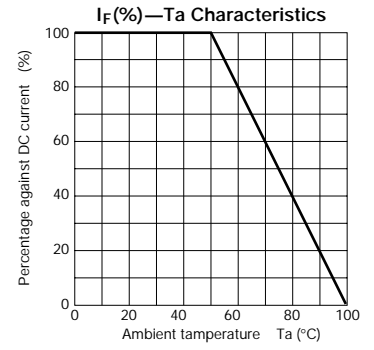
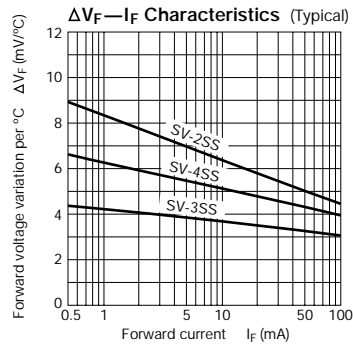
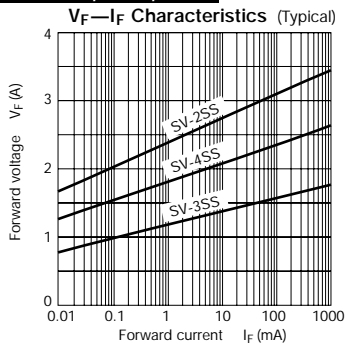

VR-60SS, 61SS

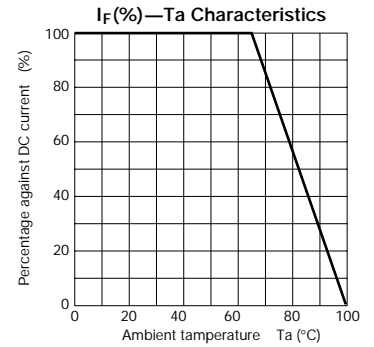
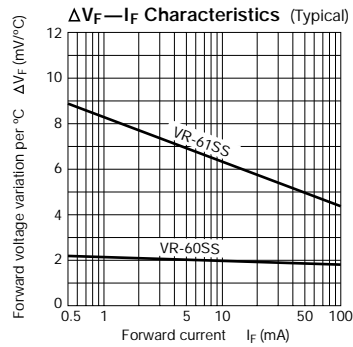
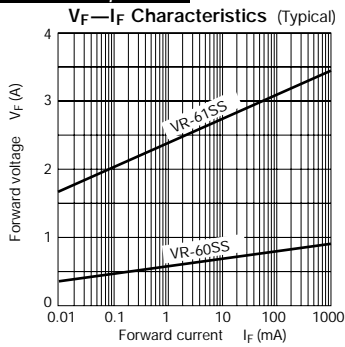

SV 02YS, 03YS, 04YS, 05YS, 06YS

