

240 Amp Schottky Rectifier

HS24135 — HS24145

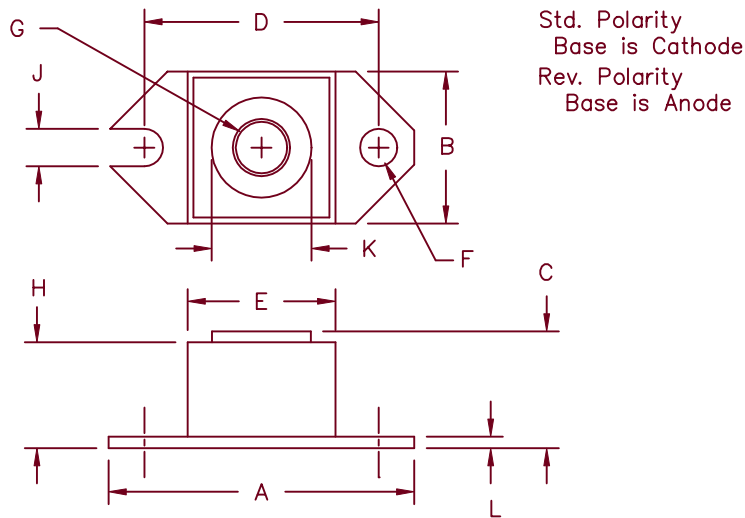

Std. Polarity
Base is Cathode
Rev. Polarity
Base is Anode

Dim.	Inches		Millimeter		Notes
	Minimum	Maximum	Minimum	Maximum	
A	1.52	1.56	38.86	39.62	
B	.725	.775	18.42	19.69	
C	.605	.625	15.37	15.88	
D	1.182	1.192	30.02	30.28	
E	.745	.755	18.92	19.18	Sq.
F	.152	.160	3.86	4.06	Dia.
G			1/4-20 UNC-2B		
H	.570	.580	14.49	14.73	
J	.156	.160	3.96	4.06	
K	.495	.505	12.57	12.83	Dia.
L	.120	.130	3.05	3.30	

Microsemi Catalog Number	Industry Part Number	Working Peak Reverse Voltage	Repetitive Peak Reverse Voltage
HS24135*	241NQ035	35V	35V
HS24140*	241NQ040	40V	40V
HS24145*	241NQ045	45V	45V

*Add suffix R for Reverse Polarity

- Schottky Barrier Rectifier
- Guard ring protection
- 240 Amperes/ 45 Volts
- 175°C junction temperature
- Reverse energy tested

Electrical Characteristics

Average forward current	$I_F(AV)$ 240 Amps	$T_C = 133^\circ C$, square wave, $R_{\theta JC} = 0.24^\circ C/W$
Maximum surge current	I_{FSM} 3400 Amp	8.3 ms, half sine $T_J = 175^\circ C$
Max repetitive peak reverse current	$I_{R(OV)}$ 2 Amps	$f = 1$ KHz, $25^\circ C$, 1 μ sec square wave
Max peak forward voltage	V_{FM} 0.60 Volts	$I_{FM} = 240A: T_J = 175^\circ C^*$
Max peak forward voltage	V_{FM} 0.69 Volts	$I_{FM} = 240A: T_J = 25^\circ C^*$
Max peak reverse current	I_{RM} 200mA	$V_{RRM}, T_J = 125^\circ C^*$
Max peak reverse current	I_{RM} 10 mA	$V_{RRM}, T_J = 25^\circ C$
Typical junction capacitance	C_J 9500 pF	$V_R = 5.0V, T_J = 25^\circ C$

*Pulse test: Pulse width 300 μ sec, Duty cycle 2%

Thermal and Mechanical Characteristics

Storage temp range	T_{STG}	$-55^\circ C$ to $175^\circ C$
Operating junction temp range	T_J	$-55^\circ C$ to $175^\circ C$
Maximum thermal resistance	$R_{\theta JC}$	$0.24^\circ C/W$ Junction to case
Typical thermal resistance (greased)	$R_{\theta CS}$	$0.12^\circ C/W$ Case to sink
Terminal torque		35-40 inch pounds
Mounting Base torque		20-25 inch pounds
Weight		1.1 ounces (32 grams)

HS24135 — HS24145

Figure 1
Typical Forward Characteristics

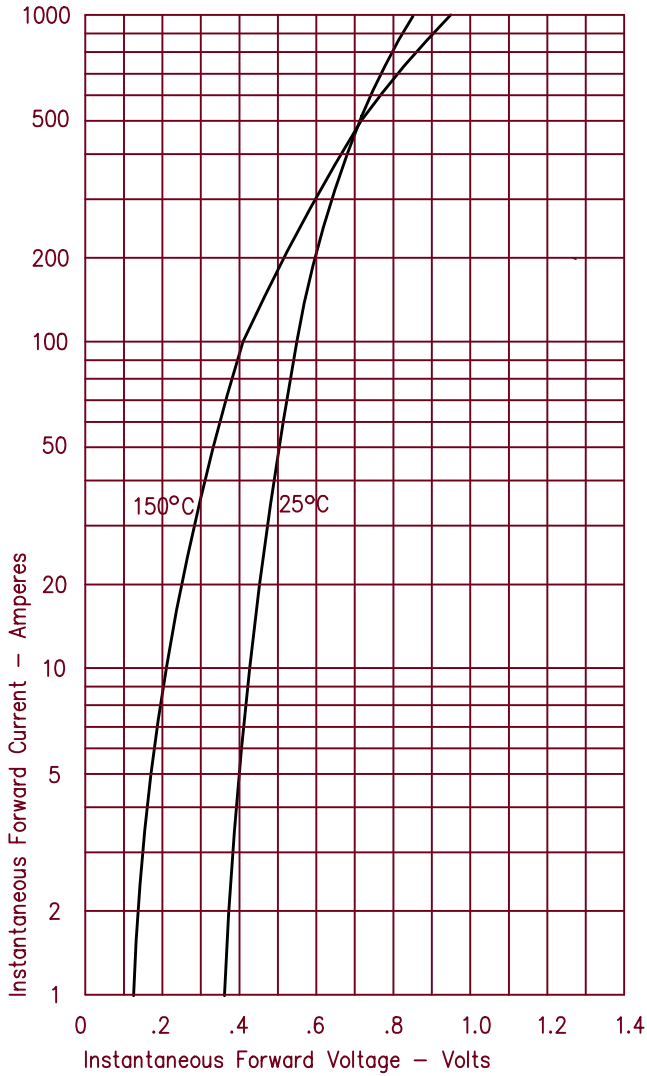

Figure 3
Typical Junction Capacitance

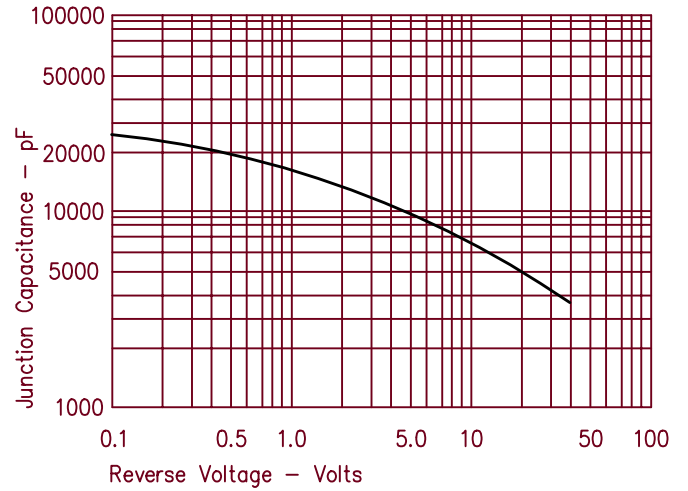

Figure 4
Forward Current Derating

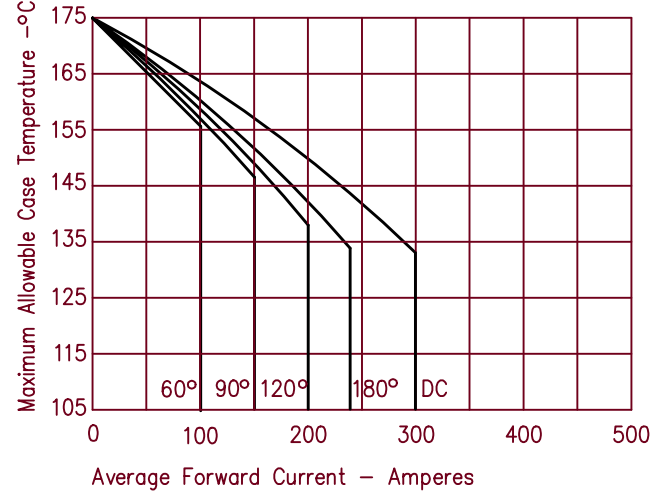

Figure 2
Typical Reverse Characteristics

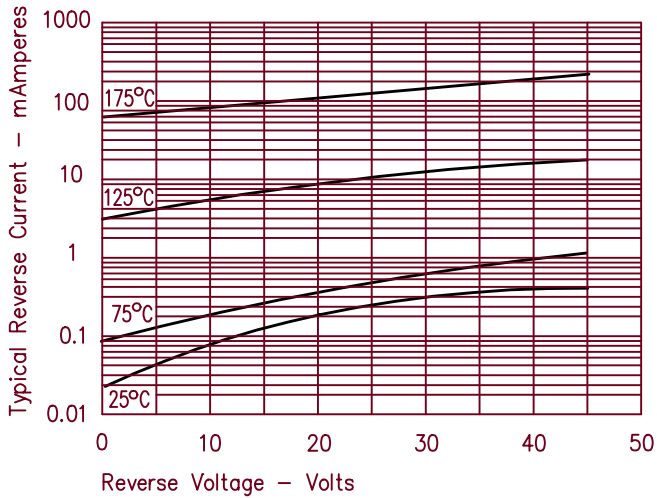
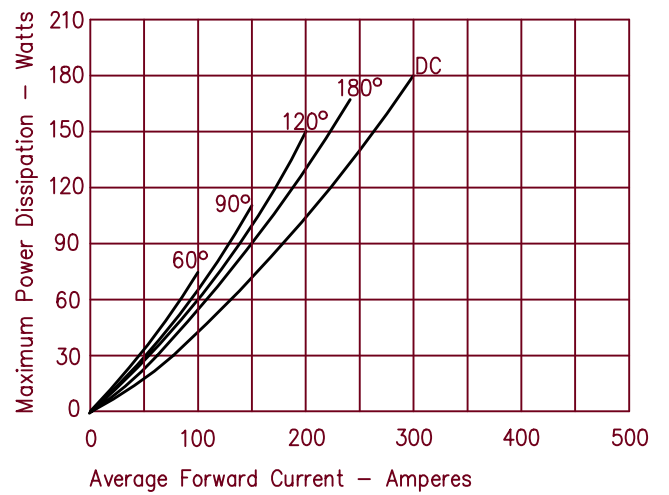

Figure 5
Maximum Forward Power Dissipation





LittleDiode supplies new, hard to find or obsolete electronic components and semiconductors all over the world.

With over two million different components listed you are sure to find the part you need.

Feel free to visit us today at our online store:

LittleDiode.com

Looking forward to providing you with the best possible service.