

High Voltage Encapsulated Assemblies EF Half Wave Series

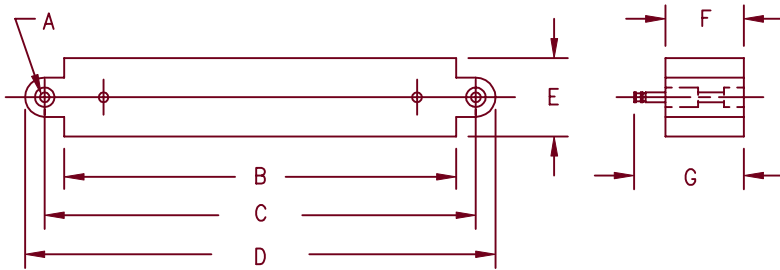

Dimensions			
	Inches	Millimeters	Notes
A	---	---	1
B	5.50	139.7	
C	6.00	152.4	
D	6.625	168.3	
E	1.25	31.8	
F	1.25	31.8	
G	1.688	42.88	

Note 1: .2031" (5.159 mm) Dia. Hole

Microsemi Catalog Number	Max. PRV Rating Per Circuit Arm
EF*H16	16 KV
EF*H20	20 KV

*Add T for Turret Terminals
*Add F for Faston Terminals
*Add L for Flexible Lead (min length=4")

- Encapsulated assembly
- Half Wave
- Half Wave rating up to 20,000 PRV
- Completely sealed, compact, corrosion and moisture resistant

Electrical Characteristics	
Circuit:	Single half wave
AC Input:	Up to 20,000 PRV
DC Output:	Up to 1.25 Amps DC (see curve)
Surge Current Rating:	15 Amps peak for one cycle
Loads:	Resistive, Inductive, Capacitive, Continuous
Duty Cycle:	Continuous
Cooling:	Convection

Single-phase half wave current ratings

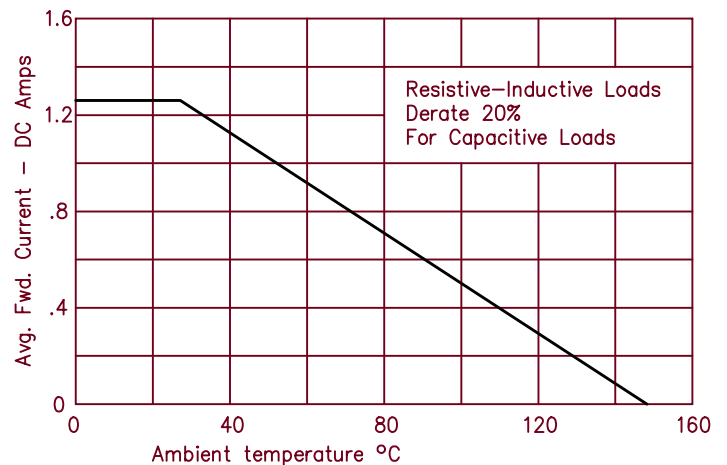

3-12-01 Rev. 1



LittleDiode supplies new, hard to find or obsolete electronic components and semiconductors all over the world.

With over two million different components listed you are sure to find the part you need.

Feel free to visit us today at our online store:

LittleDiode.com

Looking forward to providing you with the best possible service.