

COMPLEMENTARY SILICON POWER TRANSISTORS

...designed for various specific and general purpose application such as; output and driver stages of amplifiers operating at frequencies from DC to greater than 1.0MHz series, shunt and switching regulators; low and high frequency inverters/converters and many others.

FEATURES:

- * Very Low Collector Saturation Voltage
- * Excellent Linearity
- * Fast Switching
- * PNP Values are Negative, Observe Proper Polarity.

Boca Semiconductor Corp.

BSC

<http://www.bocasemi.com>

NPN	PNP
D44C	D45C
Series	Series

4 AMPERE
COMPLEMENTARY SILICON
POWER TRANSISTORS
30-80 VOLTS
30 WATTS

MAXIMUM RATINGS

Characteristic	Symbol	D44C1,2,3	D44C4,5,6	D44C7,8,9	D44C10,11,12	Unit
		D45C1,2,3	D45C4,5,6	D45C7,8,9	D45C10,11,12	
Collector-Emitter Voltage	V_{CEO}	30	45	60	80	V
Collector-Emitter Voltage	V_{CES}	40	55	70	90	V
Emitter-Base Voltage	V_{EBO}	5.0				V
Collector Current - Continuous Peak	I_C	4.0				A
	I_{CM}	6.0				
Base Current	I_B	1.0				A
Total Power Dissipation @ $T_C = 25^\circ\text{C}$ Derate above 25°C	P_D	30				W
		0.24				
Operating and Storage Junction Temperature Range	T_J, T_{STG}	-55 to +150				$^\circ\text{C}$

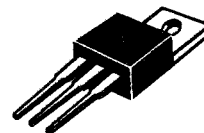

TO-220

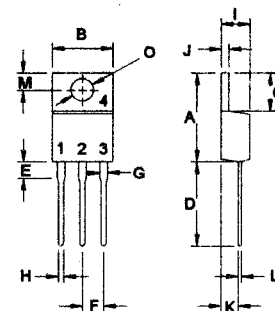

PIN 1.BASE
2.COLLECTOR
3.EMITTER
4.COLLECTOR(CASE)

THERMAL CHARACTERISTICS

Characteristic	Symbol	Max	Unit
Thermal Resistance Junction to Case	$R_{\theta JC}$	4.2	$^\circ\text{C}/\text{W}$

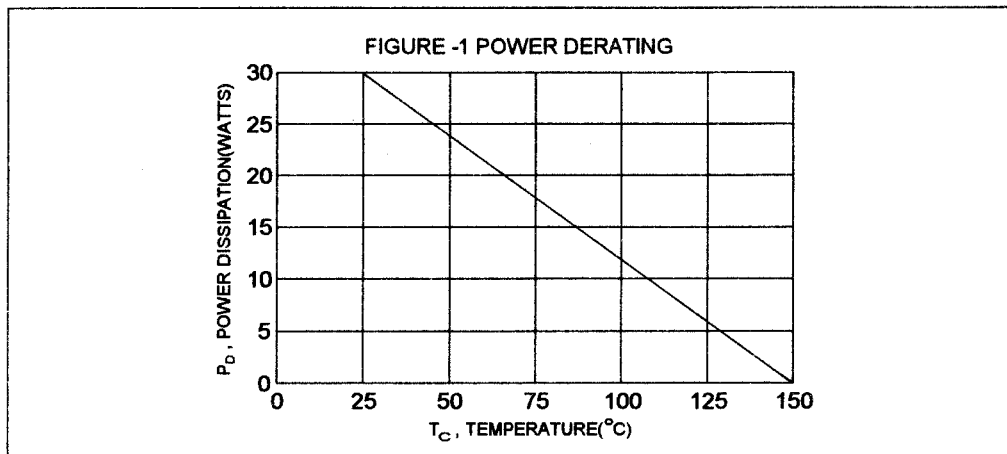

DIM	MILLIMETERS	
	MIN	MAX
A	14.68	15.31
B	9.78	10.42
C	5.01	6.52
D	13.06	14.62
E	3.57	4.07
F	2.42	3.66
G	1.12	1.36
H	0.72	0.96
I	4.22	4.98
J	1.14	1.38
K	2.20	2.97
L	0.33	0.55
M	2.48	2.98
O	3.70	3.90

ELECTRICAL CHARACTERISTICS ($T_c = 25^\circ\text{C}$ unless otherwise noted)

Characteristic	Symbol	Min	Max	Unit
----------------	--------	-----	-----	------

OFF CHARACTERISTICS

Collector-Base Cutoff Current ($V_{CE} = \text{Rated } V_{CES}$)	I_{CES}		10	μA
Emitter-Base Cutoff Current ($V_{EB} = 5.0\text{ V}$, $I_C = 0$)	I_{EBO}		100	μA

ON CHARACTERISTICS(1)

DC Current Gain ($I_C = 0.2\text{ A}$, $V_{CE} = 1.0\text{ V}$)	D44C3,6,9,12/ D45C3,6,9,12 D44C2,5,8,11 D45C2,5,8,11	h_{FE}	40 100 40	120 220 120	
($I_C = 1.0\text{ A}$, $V_{CE} = 1.0\text{ V}$)	D44C1,4,7,10/D45C1,4,7,10 D44C1,4,7,10/D45C1,4,7,10 D45C2,5,8,11		25 10 20		
($I_C = 2.0\text{ A}$, $V_{CE} = 1.0\text{ V}$)	D44C3,6,9,12/ D45C3,6,9,12 D44C2,5,8,11		20 20		
Collector-Emitter Saturation Voltage ($I_C = 1.0\text{ A}$, $I_B = 50\text{ mA}$)	D44C2,3,5,6,8,9,11,12 D45C2,3,5,6,8,9,11,12	$V_{CE(sat)}$		0.5 0.5	V
($I_C = 1.0\text{ A}$, $I_B = 100\text{ mA}$)	D44C1,4,7,10/D45C1,4,7,10			0.5	
Base-Emitter Saturation Voltage ($I_C = 1.0\text{ A}$, $I_B = 100\text{ mA}$)	All Devices	$V_{BE(sat)}$		1.3	V

DYAMIC CHARATERISTICS

Current-Gain Bandwidth Product (2) ($I_C = 20\text{ mA}$, $V_{CE} = 4.0\text{ V}$, $f = 1.0\text{ MHz}$)	D44C Series D45C Series	f_T	50(typ) 40(typ)		MHz
---	----------------------------	-------	--------------------	--	-----

SWITCHING CHARATERISTICS

Rise Time	$V_{CC} = 20\text{ V}$ $I_C = 1.0\text{ A}$, $I_{B1} = -I_{B2} = 100\text{ mA}$	D44C Series D45C Series	t_r	0.3 0.2	μs
Storage Time		D44C Series D45C Series	t_s	0.7 0.6	μs
Fall Time		D44C Series D45C Series	t_f	0.4 0.3	μs

(1) Pulse Test: Pulse width = 300 μs , Duty Cycle $\leq 2.0\%$ (2) $f_T = |h_{fe}| \cdot f_{test}$

DC CURRENT GAIN

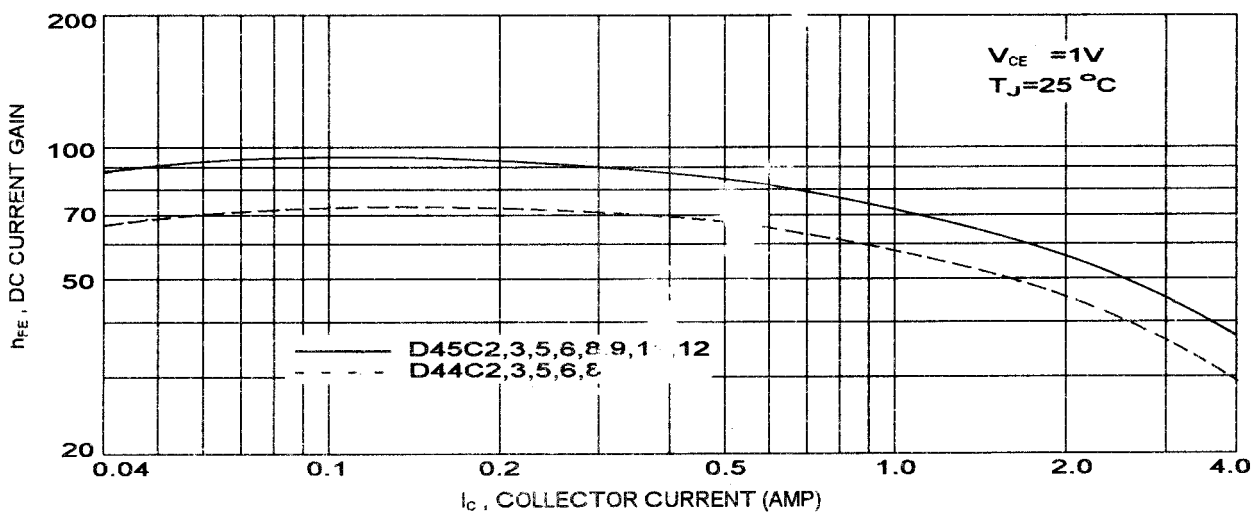

FORWARD BIAS SAFE OPERATING AREA

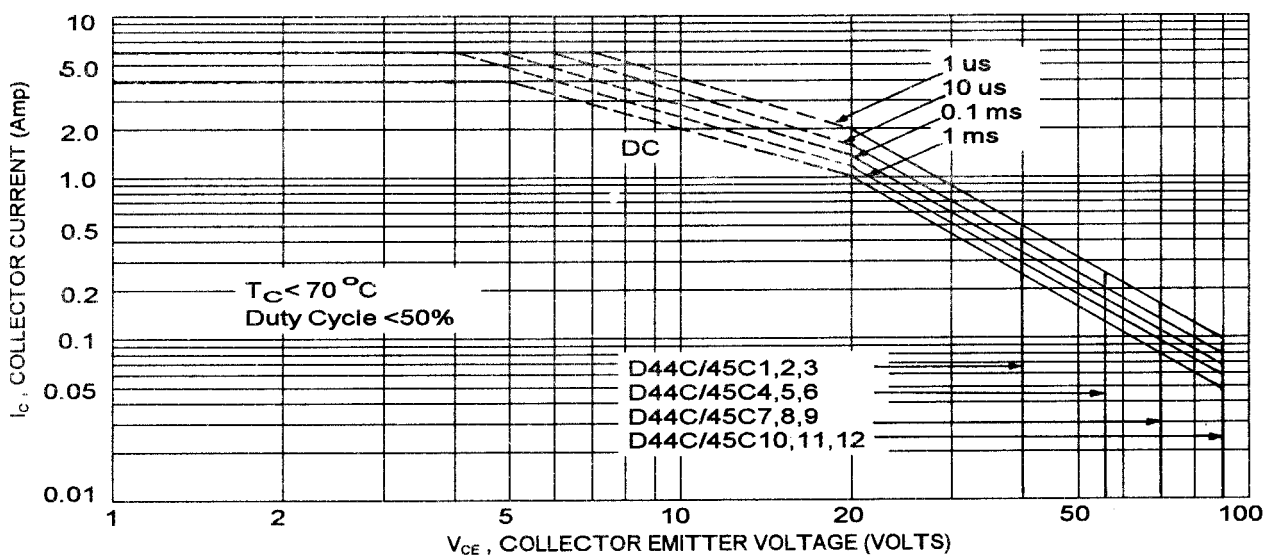

Boca Semiconductor Corp.
 BSC
<http://www.bocasemi.com>



LittleDiode supplies new, hard to find or obsolete electronic components and semiconductors all over the world.

With over two million different components listed you are sure to find the part you need.

Feel free to visit us today at our online store:

LittleDiode.com

Looking forward to providing you with the best possible service.