

SOT23 NPN PLANAR SMALL SIGNAL TRANSISTORS

BCW71
BCW72

ISSUE 2 – FEBRUARY 1995

PARTMARKING DETAILS – BCW71 – K1
BCW72 – K2
BCW71R – K4
BCW72R – K5

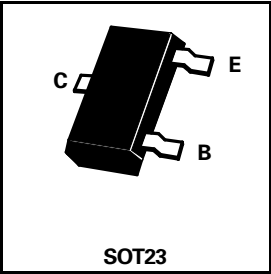

ABSOLUTE MAXIMUM RATINGS.

| PARAMETER | SYMBOL | VALUE | UNIT |
|--|-----------|-------------|-------------|
| Collector-Base Voltage | V_{CBO} | 50 | V |
| Collector-Emitter Voltage | V_{CEO} | 45 | V |
| Emitter-Base Voltage | V_{EBO} | 5 | V |
| Peak Pulse Current | I_{CM} | 200 | mA |
| Continuous Collector Current | I_C | 100 | mA |
| Power Dissipation at $T_{amb}=25^{\circ}C$ | P_{TOT} | 330 | mW |
| Operating and Storage Temperature Range | tj:tstg | -55 to +150 | $^{\circ}C$ |

ELECTRICAL CHARACTERISTICS (at $T_{amb} = 25^{\circ}C$ unless otherwise stated).

| PARAMETER | SYMBOL | MIN. | TYP. | MAX. | UNIT | CONDITIONS. |
|---------------------------------------|---------------|------|------------|------------|---------------|---|
| Collector-Base Cut-Off Current | I_{CBO} | | | 100 10 | nA μA | $I_E=0, V_{CB}=20V$ $I_E=0,$ $V_{CB}=20V, T_j=100^{\circ}C$ |
| Base-Emitter Voltage | V_{BE} | 550 | | 700 | mV | $I_C=2.0mA, V_{CE}=5V$ |
| Collector-Emitter Saturation Voltage | $V_{CE(sat)}$ | | 120 210 | 250 | mV mV | $I_C=10mA, I_B=0.5mA$ $I_C=50mA, I_B=2.5mA$ |
| Base-Emitter Saturation Voltage | $V_{BE(sat)}$ | | 750 850 | | mV mV | $I_C=10mA, I_B=0.5mA$ $I_C=50mA, I_B=2.5mA$ |
| Static Forward Current Transfer Ratio | h_{FE} | 110 | 90 | 220 | | $I_C=10\mu A, V_{CE}=5V$ $I_C=2mA, V_{CE}=5V$ |
| | | | 200 | 150 450 | | $I_C=10\mu A, V_{CE}=5V$ $I_C=2mA, V_{CE}=5V$ |
| Transition Frequency | f_T | | 300 | | MHz | $I_C=10mA, V_{CE}=5V$ $f=35MHz$ |
| Collector Capacitance | C_{TC} | | | 4 | pF | $I_E=I_e=0, V_{CB}=10V$ $f=1MHz$ |
| Noise Figure | N | | | 10 | dB | $I_C=200\mu A, V_{CE}=5V$ $R_S=2K\Omega, f=1KHz$ $B=200Hz$ |

*Measured under pulsed conditions. Pulse width=300 μs . Duty cycle $\leq 2\%$

Spice parameter data is available upon request for these devices

BCW71 BCW72

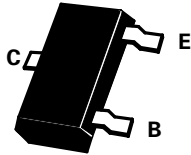

| DIM | Millimeters | | Inches | |
|-----|-------------|------|-----------|--------|
| | Min | Max | Min | Max |
| A | 2.67 | 3.05 | 0.105 | 0.120 |
| B | 1.20 | 1.40 | 0.047 | 0.055 |
| C | - | 1.10 | - | 0.043 |
| D | 0.37 | 0.53 | 0.0145 | 0.021 |
| F | 0.085 | 0.15 | 0.0033 | 0.0059 |
| G | NOM 1.9 | | NOM 0.075 | |
| K | 0.01 | 0.10 | 0.0004 | 0.004 |
| L | 2.10 | 2.50 | 0.0825 | 0.0985 |
| N | NOM 0.95 | | NOM 0.37 | |

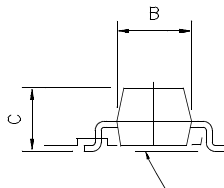
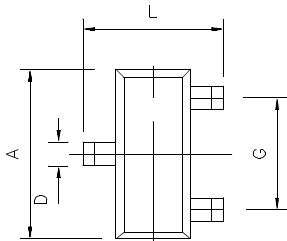

STAND OFF HEIGHT K

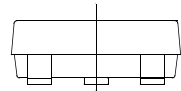



LittleDiode supplies new, hard to find or obsolete electronic components and semiconductors all over the world.

With over two million different components listed you are sure to find the part you need.

Feel free to visit us today at our online store:

LittleDiode.com

Looking forward to providing you with the best possible service.