

### OUTLINE DRAWING

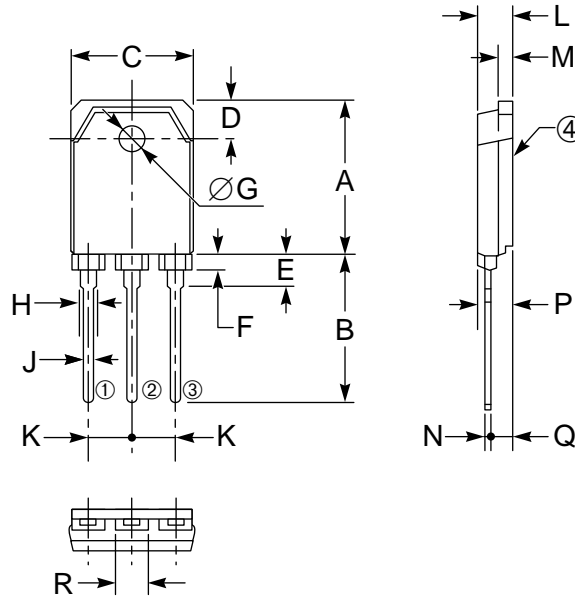

### CONNECTION DIAGRAM

- ① T1 TERMINAL
- ② T2 TERMINAL
- ③ GATE
- ④ T2 TERMINAL

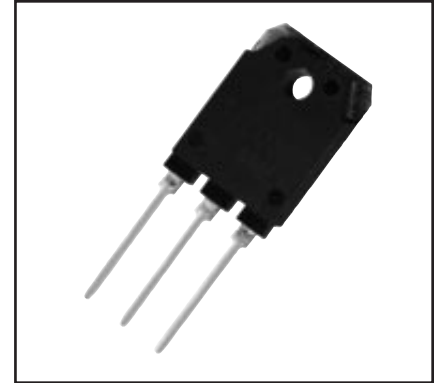
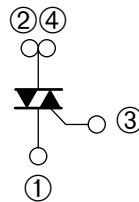

### Description:

A triac is a solid state silicon AC switch which may be gate triggered from an off-state to an on-state for either polarity of applied voltage.

### Features:

- Planar Passivation
- Selected for Inductive Loads

### Applications:

- Contactless AC Switches
- Microwave Ovens
- Motor Controls
- Lighting Controls

### Ordering Information:

Example: Select the complete eight, nine or ten digit part number you desire from the table - i.e. BCR30AM-8 is a 400 Volt, 30 Ampere Triac.

Outline Drawing (Conforms to TO-3P)

Dimensions	Inches	Millimeters
A	0.79	20.0
B	0.77	19.5
C	0.63	15.9
D	0.20	5.0
E	0.16	4.0
F	0.08	2.0
G	0.13 Dia.	3.2 Dia.
H	0.08	2.0

Dimensions	Inches	Millimeters
J	0.04	1.0
K	0.21	5.45
L	0.18	4.5
M	0.06	1.5
N	0.02	0.6
P	0.17	4.4
Q	0.11	2.8
R	0.16	4.0

Type	V <sub>DRM</sub> Volts	Code	Inductive Load*
BCR30AM	400	-8	L
	600	-12	

\*For inductive load, add L.

## BCR30AM

### Triac

30 Ampere/400-600 Volts

### Absolute Maximum Ratings, $T_a = 25\text{ }^\circ\text{C}$ unless otherwise specified

Ratings	Symbol	BCR30AM-8	BCR30AM-12	Units
On-state Current, $T_c = 75^\circ\text{C}$	$I_{T(RMS)}$	30	30	Amperes
Repetitive Peak Off-state Voltage (Gate Open)	$V_{DRM}$	400	600	Volts
Non-repetitive Peak Off-state Voltage (Gate Open)	$V_{DSM}$	500	720	Volts
Non-repetitive Peak On-state Voltage, One Cycle (60 Hz)	$I_{TSM}$	300	300	Amperes
$I^2t$ for Fusing, $t = 8.3\text{ msec}$	$I^2t$	378	378	$\text{A}^2\text{sec}$
Peak Gate Power Dissipation, $20\text{ }\mu\text{sec}$	$P_{GM}$	5	5	Watts
Average Gate Power Dissipation	$P_{G(avg)}$	0.5	0.5	Watts
Peak Gate Current	$I_{GM}$	2	2	Amperes
Peak Gate Voltage	$V_{GM}$	10	10	Volts
Storage Temperature	$T_{stg}$	-40 to 125	-40 to 125	$^\circ\text{C}$
Operating Temperature	$T_j$	-40 to 125	-40 to 125	$^\circ\text{C}$
Weight	–	4.8	4.8	Grams

### Electrical and Thermal Characteristics, $T_j = 25\text{ }^\circ\text{C}$ unless otherwise specified

Characteristics	Symbol	Test Conditions (Trigger Mode)				BCR30GM			Units
		$V_D$	$R_L$	$R_G$	$T_j$	Min.	Typ.	Max.	
Gate Parameters									
DC Gate Trigger Current									
MT2+ Gate+	$I_{FGT\ I}$	6V	6 $\Omega$	330 $\Omega$	25 $^\circ\text{C}$	–	–	50	mA
MT2+ Gate–	$I_{RGT\ I}$	6V	6 $\Omega$	330 $\Omega$	25 $^\circ\text{C}$	–	–	50	mA
MT2– Gate–	$I_{RGT\ III}$	6V	6 $\Omega$	330 $\Omega$	25 $^\circ\text{C}$	–	–	50	mA
DC Gate Trigger Voltage									
MT2+ Gate+	$V_{FGT\ I}$	6V	6 $\Omega$	330 $\Omega$	25 $^\circ\text{C}$	–	–	2.5	Volts
MT2+ Gate–	$V_{RGT\ I}$	6V	6 $\Omega$	330 $\Omega$	25 $^\circ\text{C}$	–	–	2.5	Volts
MT2– Gate–	$V_{RGT\ III}$	6V	6 $\Omega$	330 $\Omega$	25 $^\circ\text{C}$	–	–	2.5	Volts
DC Gate Non-trigger Voltage									
All	$V_{GD}$	1/2 $V_{DRM}$	–	–	125 $^\circ\text{C}$	0.2	–	–	Volts

Characteristics	Symbol	Test Conditions	Min.	Typ.	Max.	Units
Thermal Resistance, Junction-to-case	$R_{th(c-f)}$	–	–	–	1.2	$^\circ\text{C}/\text{W}$
Voltage – Blocking State Repetitive Off-state Current	$I_{DRM}$	Gate Open Circuited, $V_D = V_{DRM}$ , $T_j = 125^\circ\text{C}$	–	–	3	mA
Current – Conducting State Peak On-state Voltage	$V_{TM}$	$T_c = 25^\circ\text{C}$ , $I_{TM} = 45\text{A}$	–	–	1.6	Volts
Critical Rate-of-Rise of Commutating Off-state Voltage (Commutating $dv/dt$ ) ▲ (Switching)	$(dv/dt)_c$	–	–	–	–	$\text{V}/\mu\text{s}$



Powerex, Inc., 200 Hillis Street, Youngwood, Pennsylvania 15697-1800 (412) 925-7272

**BCR30AM**

**Triac**

30 Ampere/400-600 Volts

**MAXIMUM ON-STATE CHARACTERISTICS**

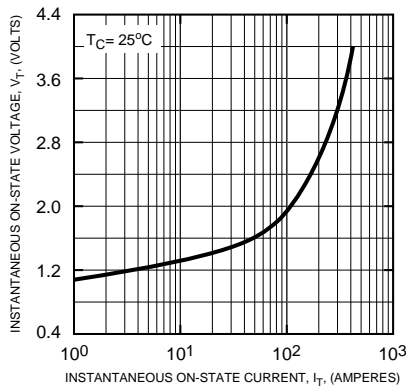

**TRANSIENT THERMAL IMPEDANCE CHARACTERISTICS**

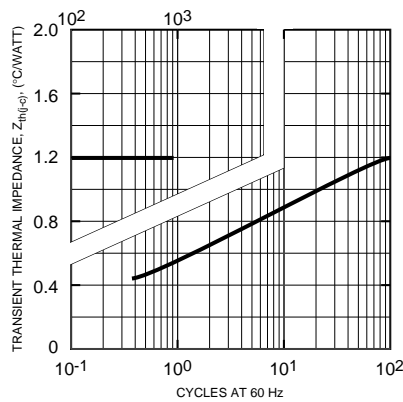

**GATE CHARACTERISTICS (I, II, III)**

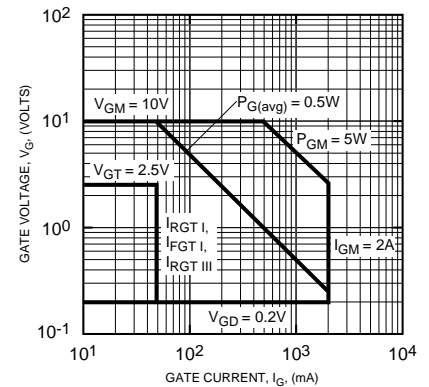

**MAXIMUM SURGE CURRENT FOLLOWING RATED LOAD CONDITIONS**

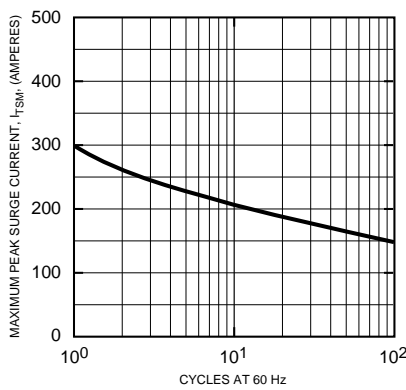

**ALLOWABLE CASE TEMPERATURE VS. RMS ON-STATE CURRENT**

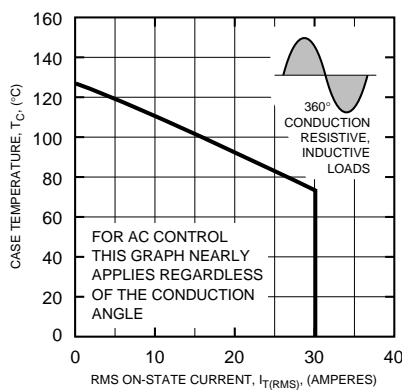

**ALLOWABLE AMBIENT TEMPERATURE VS. RMS ON-STATE CURRENT**

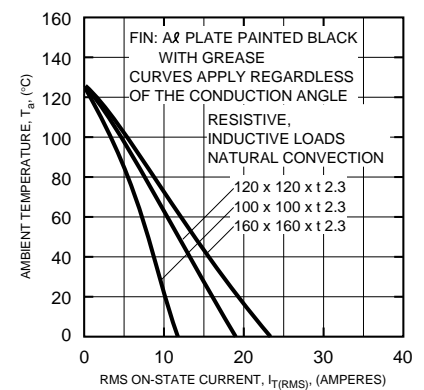

**MAXIMUM ON-STATE POWER DISSIPATION**

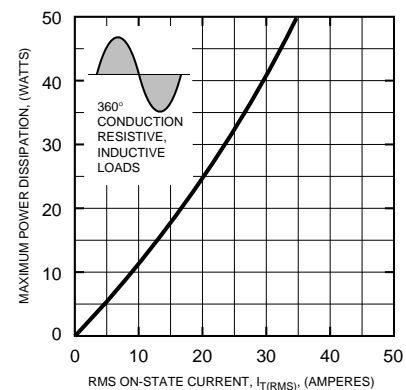

**GATE TRIGGER CURRENT VS. JUNCTION TEMPERATURE (TYPICAL)**

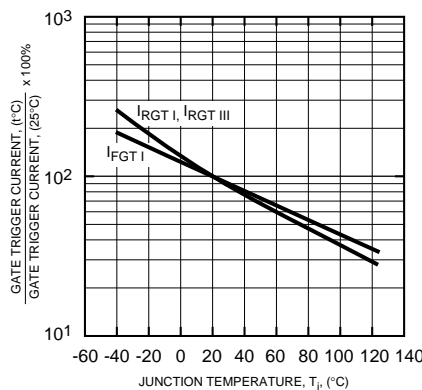

**GATE TRIGGER VOLTAGE VS. JUNCTION TEMPERATURE (TYPICAL)**

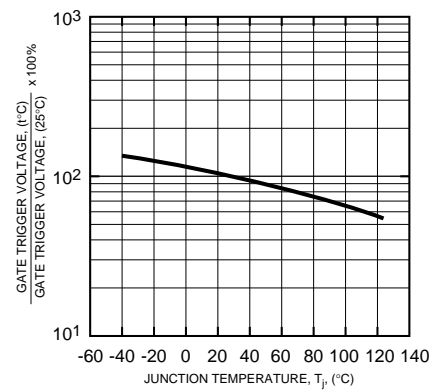

## BCR30AM

### Triac

30 Ampere/400-600 Volts

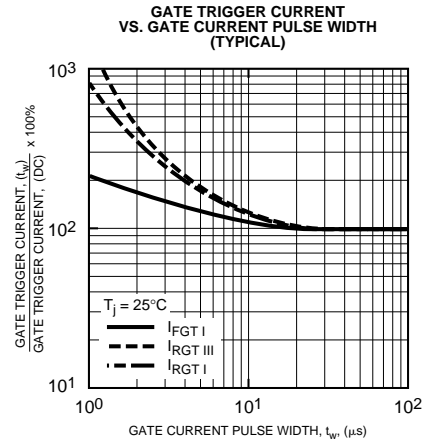
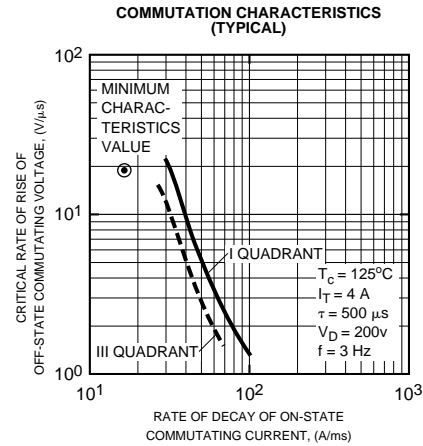
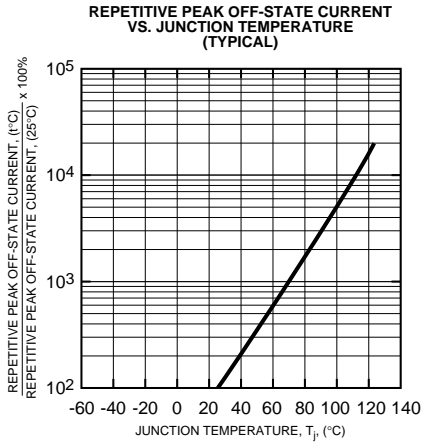
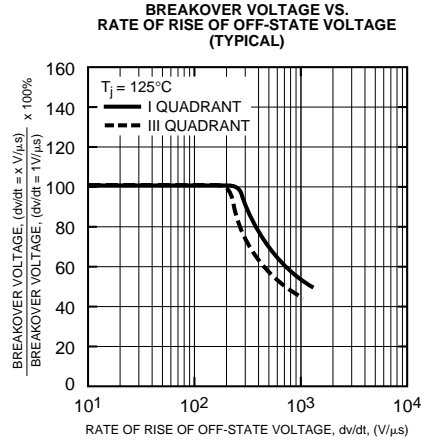
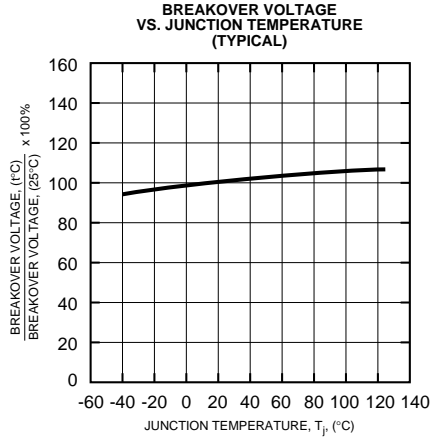
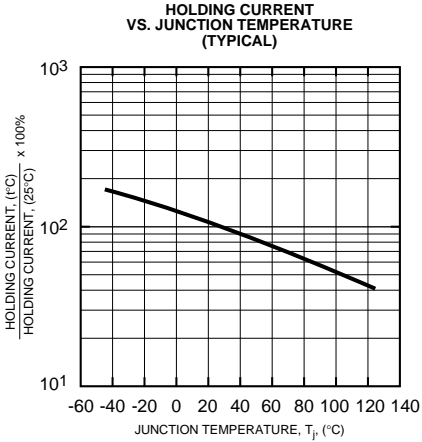

### GATE TRIGGER CHARACTERISTICS TEST CIRCUITS

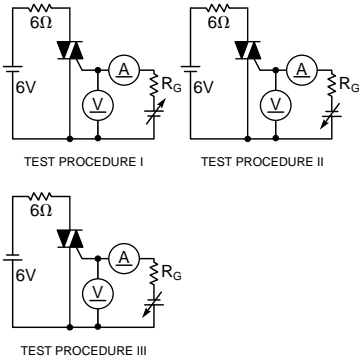

Δ Part Number	V <sub>DRM</sub> (Volts)	Commutating dv/dt, (dv/dt) <sub>C</sub> (V/μsec)		Test Condition	Commutating Voltage & Current Waveform (Inductive Load)
		Minimum	Maximum		
BCR30AM-8L	400	20		$T_J = 125^\circ\text{C}$ , Rate of Decay On-state Commutating Current (di/dt) <sub>C</sub> = -016A/msec, Peak Off-state Voltage $V_D = 400\text{ V}$	
BCR30AM-12L	600	20			



LittleDiode supplies new, hard to find or obsolete electronic components and semiconductors all over the world.

With over two million different components listed you are sure to find the part you need.

Feel free to visit us today at our online store:

[LittleDiode.com](http://LittleDiode.com)

Looking forward to providing you with the best possible service.