

**N-CHANNEL SILICON POWER MOSFET
FOR BASE STATION OF 900 MHz BAND CELLULAR PHONE
POWER AMPLIFICATION**

FEATURES

- High output, high gain
 $P_o = 100\text{ W}$, $G_L = 13\text{ dB}$ (TYP.) ($f = 900\text{ MHz}$)
 $P_o = 90\text{ W}$, $G_L = 12\text{ dB}$ (TYP.) ($f = 960\text{ MHz}$)
- Low intermodulation distortion
- Covers all base station frequencies such as 800-MHz PDC and GSM
- High-reliability gold electrodes
- Hermetic sealed package
- Internal matching circuit
- Push-pull structure

ABSOLUTE MAXIMUM RATINGS ($T_A = 25\text{ }^\circ\text{C}$)

Parameter	Symbol	Ratings	Unit
Drain-source voltage	V_{DS}	60	V
Gate-source voltage	V_{GS}	7	V
Drain current (D.C.)	I_D	15 ^{Note}	A
Total power dissipation	P_T	290	W
Thermal resistance	R_{th}	0.6	$^\circ\text{C/W}$
Channel temperature	T_{ch}	200	$^\circ\text{C}$
Storage temperature	T_{stg}	-65 to +150	$^\circ\text{C}$

Note Per side

ELECTRICAL CHARACTERISTICS ($T_A = 25\text{ }^\circ\text{C}$)

Parameter	Symbol	Condition	MIN.	TYP.	MAX.	Unit
Gate leakage current	I_{GSS}	$V_{GS} = 7\text{ V}$			1	μA
Cut-off voltage	$V_{GS(off)}$	$V_{DS} = 5\text{ V}$, $I_D = 50\text{ mA}$	1.5		4	V
Drain current	I_{DSS}	$V_{DS} = 60\text{ V}$			2	mA
Mutual conductance	g_m	$V_{DS} = 5\text{ V}$, $I_D = 3\text{ A}$, $\Delta I_D = 100\text{ mA}$	2.0			S
Output power	P_o	$f = 960\text{ MHz}$, $V_{DD} = 30\text{ V}$	80	90		W
Drain efficiency	η_D	$I_{DQ} = 200\text{ mA} \times 2$, $P_{in} = 40\text{ dBm}$	35	40		%
Linear gain	G_L	$f = 960\text{ MHz}$, $V_{DD} = 30\text{ V}$ $I_{DQ} = 200\text{ mA} \times 2$, $P_{in} = 30\text{ dBm}$	11	12		dB
Third intermodulation distortion	IM_3	$f = 900\text{ MHz}$, $\Delta f = 0.1\text{ MHz}$, $V_{DD} = 30\text{ V}$ $I_{DQ} = 200\text{ mA} \times 2$, $P_o = 42\text{ dBm}$		-38		dBc

PACKAGE DRAWING (Unit: mm)

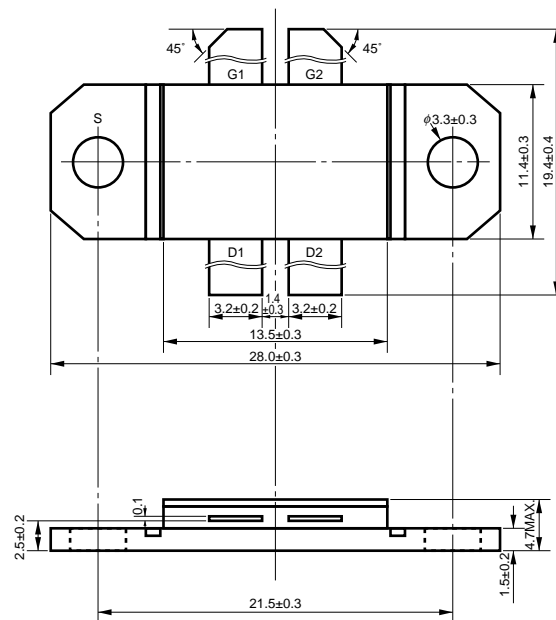

G1, G2: gate
 D1, D2: drain
 S : source
 Flange is connected to the source.

The information in this document is subject to change without notice.

OUTPUT v.s. IM₃, I_D CHARACTERISTICS

THIRD ORDER INTERMODULATION DISTORTION / DRAIN CURRENT v.s. OUTPUT POWER

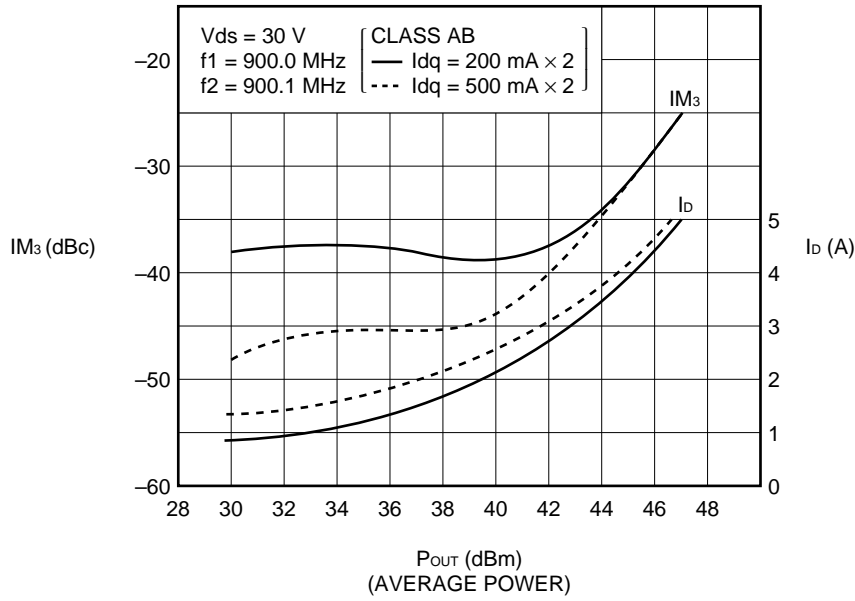

INPUT v.s. OUTPUT, POWER GAIN, EFFICIENCY

(1) $f = 960\text{ MHz}$

OUTPUT POWER / DRAIN EFFICIENCY / POWER GAIN vs. INPUT POWER

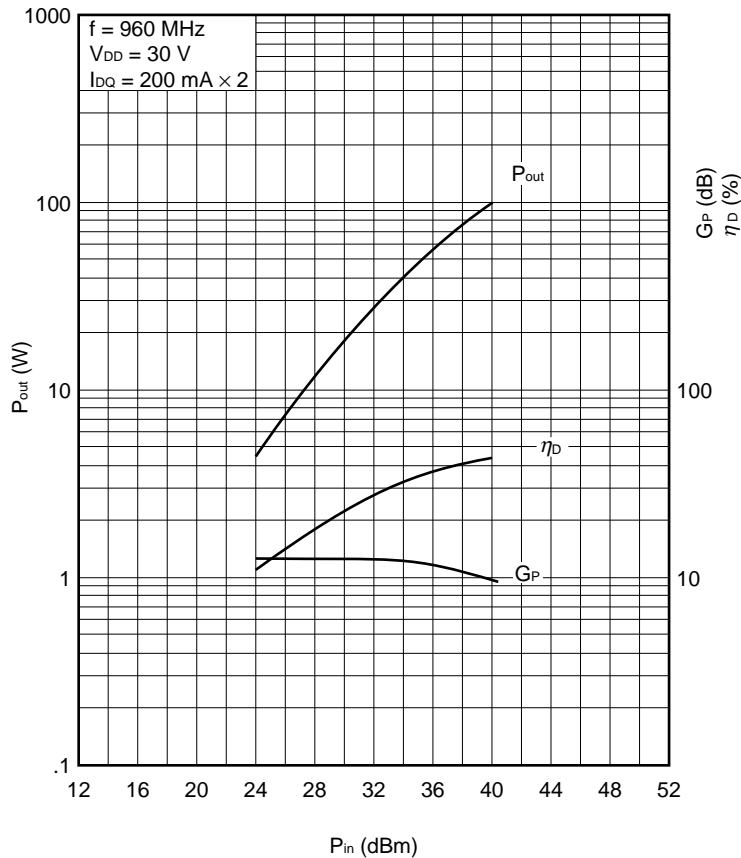

(2) $f = 900 \text{ MHz}$

OUTPUT POWER / DRAIN EFFICIENCY /
POWER GAIN vs. INPUT POWER

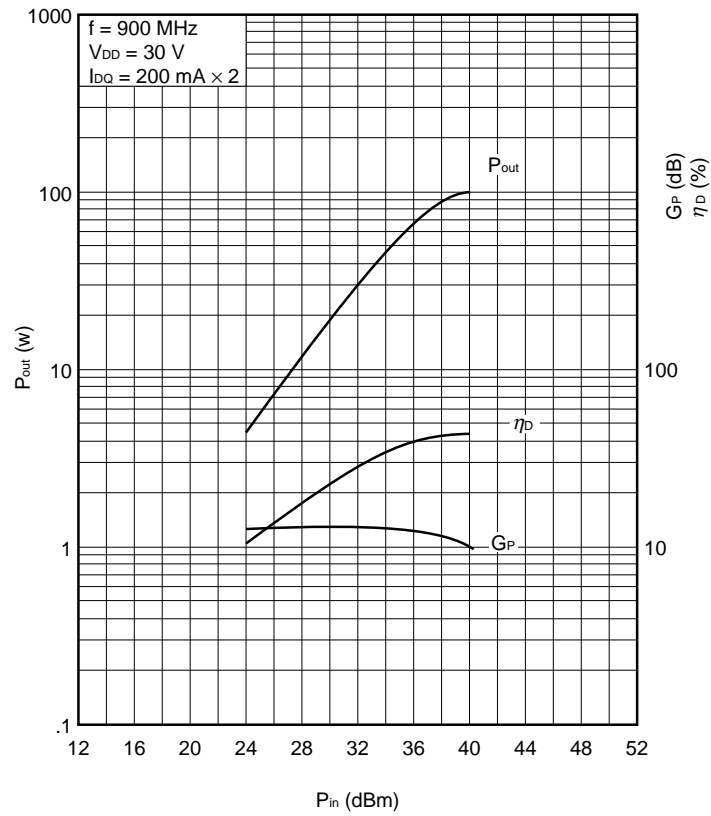

(3) $f = 820 \text{ MHz}$

OUTPUT POWER / DRAIN EFFICIENCY /
POWER GAIN vs. INPUT POWER

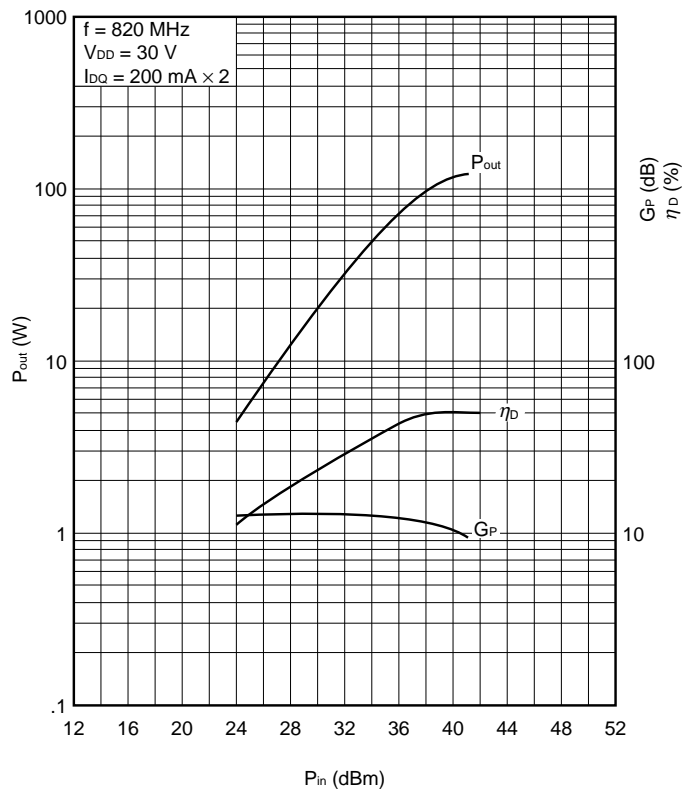

Z_{IN}, Z_{OUT}

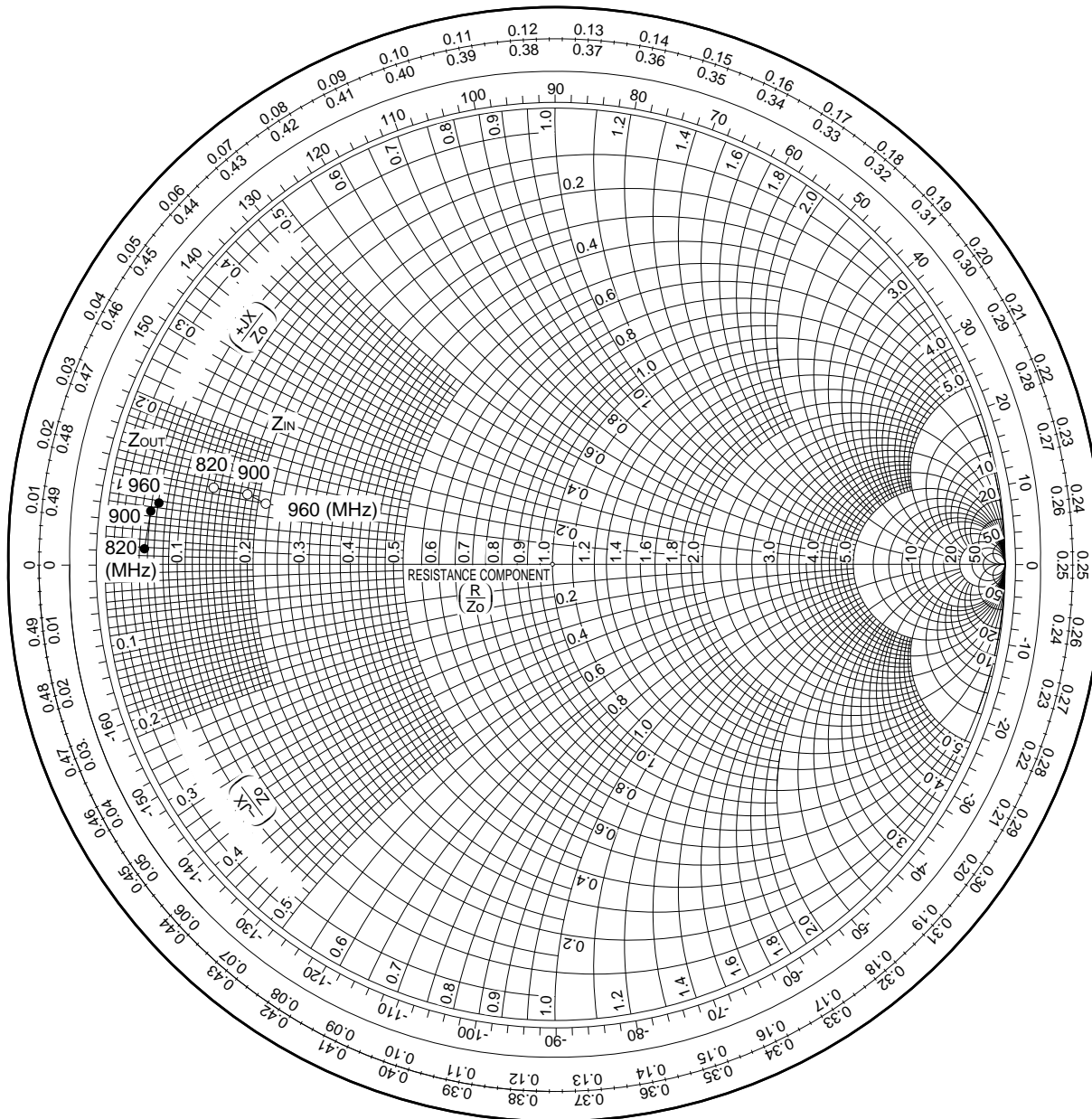

V_{DD} = 30 V, I_{DQ} = 200 mA × 2, P_{in} = 40 dBm

f (MHz)	Z _{IN} (Ω)	Z _{OUT} (Ω)
820	6.52 + j5.52	2.34 + j0.91
900	8.86 + j5.49	2.78 + j3.23
960	10.36 + j4.79	2.95 + j3.37

APPLICATION CIRCUIT EXAMPLE (f = 960 MHz)

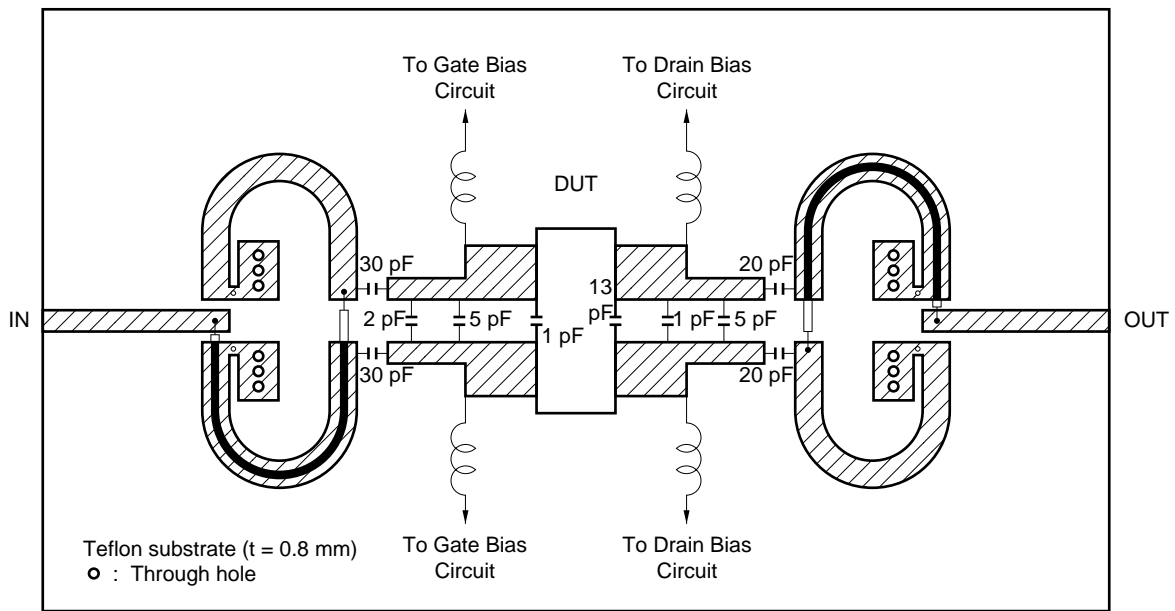

Notes on Handling

This product internally uses beryllie porcelain (beryllium oxide). If powder or vapor of beryllium oxide enters your respiratory organs, you will have a difficulty in breathing, which is dangerous. Therefore, do no disassemble or chemically process the product.

Be sure to abolish the product separately from general industrial wastes or garbage.

[MEMO]

No part of this document may be copied or reproduced in any form or by any means without the prior written consent of NEC Corporation. NEC Corporation assumes no responsibility for any errors which may appear in this document.

NEC Corporation does not assume any liability for infringement of patents, copyrights or other intellectual property rights of third parties by or arising from use of a device described herein or any other liability arising from use of such device. No license, either express, implied or otherwise, is granted under any patents, copyrights or other intellectual property rights of NEC Corporation or others.

While NEC Corporation has been making continuous effort to enhance the reliability of its semiconductor devices, the possibility of defects cannot be eliminated entirely. To minimize risks of damage or injury to persons or property arising from a defect in an NEC semiconductor device, customer must incorporate sufficient safety measures in its design, such as redundancy, fire-containment, and anti-failure features.

NEC devices are classified into the following three quality grades:

"Standard", "Special", and "Specific". The Specific quality grade applies only to devices developed based on a customer designated "quality assurance program" for a specific application. The recommended applications of a device depend on its quality grade, as indicated below. Customers must check the quality grade of each device before using it in a particular application.

Standard: Computers, office equipment, communications equipment, test and measurement equipment, audio and visual equipment, home electronic appliances, machine tools, personal electronic equipment and industrial robots

Special: Transportation equipment (automobiles, trains, ships, etc.), traffic control systems, anti-disaster systems, anti-crime systems, safety equipment and medical equipment (not specifically designed for life support)

Specific: Aircrafts, aerospace equipment, submersible repeaters, nuclear reactor control systems, life support systems or medical equipment for life support, etc.

The quality grade of NEC devices in "Standard" unless otherwise specified in NEC's Data Sheets or Data Books. If customers intend to use NEC devices for applications other than those specified for Standard quality grade, they should contact NEC Sales Representative in advance.

Anti-radioactive design is not implemented in this product.



LittleDiode supplies new, hard to find or obsolete electronic components and semiconductors all over the world.

With over two million different components listed you are sure to find the part you need.

Feel free to visit us today at our online store:

LittleDiode.com

Looking forward to providing you with the best possible service.