

# Central<sup>TM</sup> Semiconductor Corp.

145 Adams Avenue, Hauppauge, NY 11788 USA  
Tel: (631) 435-1110 • Fax: (631) 435-1824

Manufacturers of World Class Discrete Semiconductors

2N6424  
2N6425

PNP SILICON  
POWER TRANSISTOR

JEDEC TO-66 CASE

## DESCRIPTION

The CENTRAL SEMICONDUCTOR 2N6424 and 2N6225 types are PNP Silicon Power Transistors designed for high speed switching and high voltage amplifier applications.

## MAXIMUM RATINGS (T<sub>C</sub> = 25°C)

	SYMBOL	2N6424	2N6425	UNITS
Collector-Base Voltage	V <sub>CBO</sub>	250	325	V
Collector-Emitter Voltage	V <sub>CEO</sub>	225	300	V
Emitter-Base Voltage	V <sub>EBO</sub>	6.0	6.0	V
Collector Current	I <sub>C</sub>	1.0	1.0	A
Peak Collector Current	I <sub>CM</sub>	2.0	2.0	A
Base Current	I <sub>B</sub>	0.5	0.5	A
Peak Base Current	I <sub>BM</sub>	1.0	1.0	A
Power Dissipation	P <sub>D</sub>	20	20	W
Operating and Storage				
Junction Temperature	T <sub>J</sub> , T <sub>stg</sub>	-65 to +200		°C
Thermal Resistance	θ <sub>JC</sub>	8.75	8.75	°C/W

## ELECTRICAL CHARACTERISTICS (T<sub>C</sub> = 25°C unless otherwise noted)

SYMBOL	TEST CONDITIONS	2N6424		2N6425		UNITS
		MIN	MAX	MIN	MAX	
I <sub>CEV</sub>	V <sub>CE</sub> = 250V, V <sub>BE(off)</sub> = 1.5V		0.5			mA
I <sub>CEV</sub>	V <sub>CE</sub> = 300V, V <sub>BE(off)</sub> = 1.5V			0.5		mA
I <sub>CEV</sub>	V <sub>CE</sub> = 125V, V <sub>BE(off)</sub> = 1.5V, T <sub>C</sub> = 100°C		1.0			mA
I <sub>CEV</sub>	V <sub>CE</sub> = 200V, V <sub>BE(off)</sub> = 1.5V, T <sub>C</sub> = 100°C			1.0		mA
I <sub>CBO</sub>	V <sub>CE</sub> = 250V		0.1			mA
I <sub>CBO</sub>	V <sub>CE</sub> = 325V			0.1		mA
I <sub>CEO</sub>	V <sub>CE</sub> = 125V		0.25			mA
I <sub>CEO</sub>	V <sub>CE</sub> = 200V			0.25		mA
I <sub>EBO</sub>	V <sub>EB</sub> = 6.0V		0.1		0.1	mA
BV <sub>CEO</sub>	I <sub>C</sub> = 5.0mA	225		300		V
V <sub>CE(SAT)</sub>	I <sub>C</sub> = 250mA, I <sub>B</sub> = 25mA		2.5		2.5	V
V <sub>BE(ON)</sub>	V <sub>CE</sub> = 10V, I <sub>C</sub> = 100mA		1.0		1.0	V
h <sub>FE</sub>	V <sub>CE</sub> = 10V, I <sub>C</sub> = 50mA	30		30		
h <sub>FE</sub>	V <sub>CE</sub> = 10V, I <sub>C</sub> = 100mA	40	200	40	200	
h <sub>FE</sub>	V <sub>CE</sub> = 10V, I <sub>C</sub> = 250mA	25		25		
f <sub>T</sub>	V <sub>CE</sub> = 10V, I <sub>C</sub> = 100mA, f = 10MHz	10		10		MHz
C <sub>ob</sub>	V <sub>CB</sub> = 10V, I <sub>E</sub> = 0, f = 1.0MHz		120		120	pF
h <sub>fe</sub>	V <sub>CE</sub> = 20V, I <sub>C</sub> = 100mA, f = 1.0kHz	35		35		

# TO-66 CASE - MECHANICAL OUTLINE

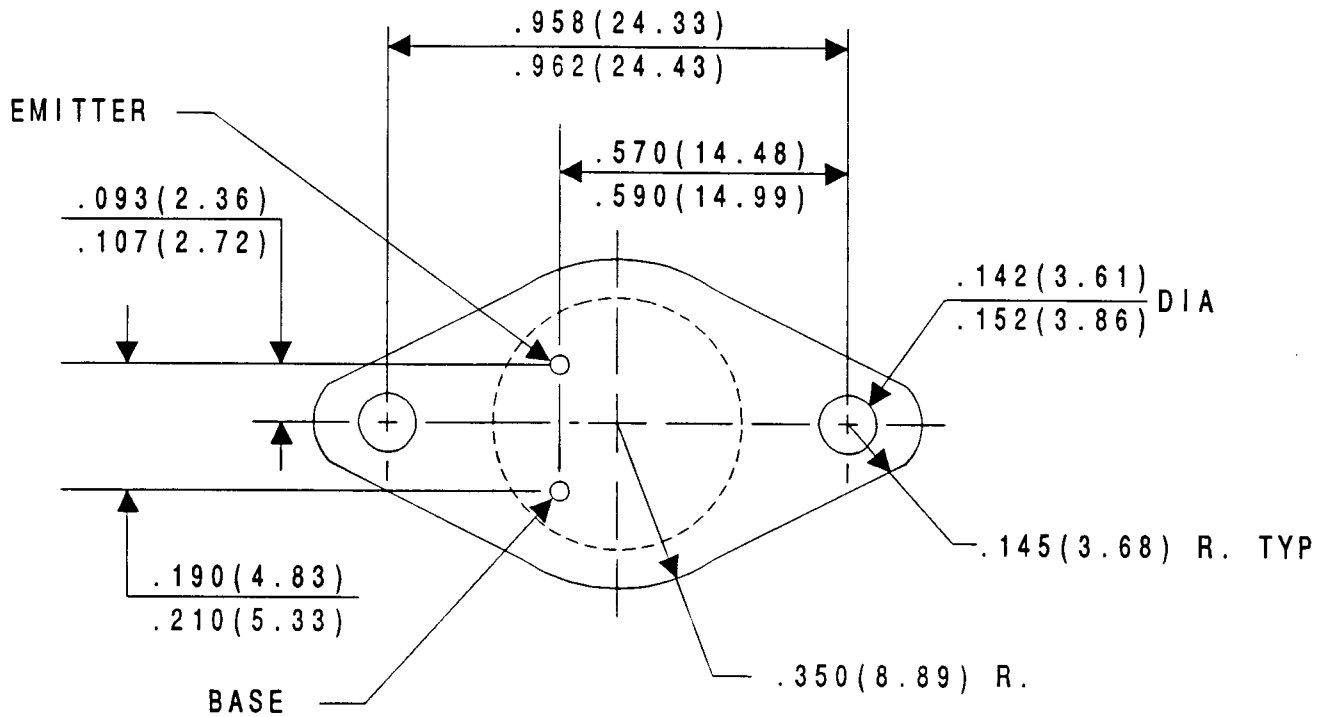
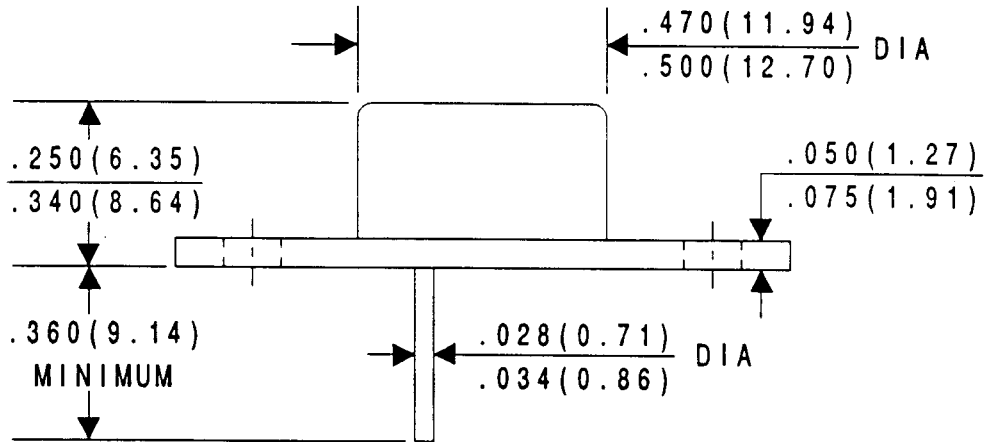

All Dimensions in Inches (mm).



LittleDiode supplies new, hard to find or obsolete electronic components and semiconductors all over the world.

With over two million different components listed you are sure to find the part you need.

Feel free to visit us today at our online store:

**[LittleDiode.com](http://LittleDiode.com)**

Looking forward to providing you with the best possible service.