

240 Amp Schottky Rectifier

HS24380 — HS243100

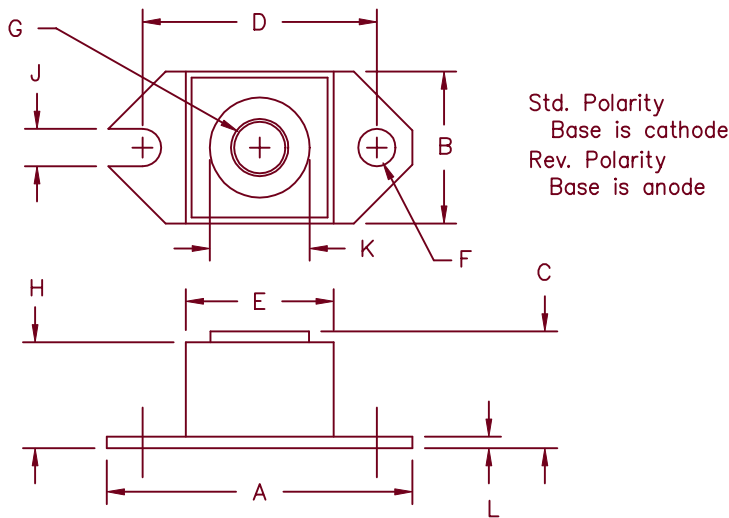

Dim.	Inches		Millimeter		Notes
	Minimum	Maximum	Minimum	Maximum	
A	1.52	1.56	38.86	39.62	
B	.725	.775	18.42	19.69	
C	.605	.625	15.37	15.88	
D	1.182	1.192	30.02	30.28	
E	.745	.755	18.92	19.18	Sq.
F	.152	.160	3.86	4.06	Dia.
G		1/4-20	UNC-2B		
H	.570	.580	14.49	14.73	
J	.156	.160	3.96	4.06	
K	.495	.505	12.57	12.83	Dia.
L	.120	.130	3.05	3.30	

Microsemi Catalog Number	Industry Part Number	Working Peak Reverse Voltage	Repetitive Peak Reverse Voltage
HS24380*	243NQ080	80V	80V
HS24390*	MBR24080	90V	90V
HS243100*	243NQ100	100V	100V
	MBR240100		

*Add Suffix R for Reverse Polarity

- Schottky Barrier Rectifier
- Guard Ring Protection
- 240 Amperes/80 to 100 Volts
- 175°C Junction Temperature
- Reverse Energy Tested

Electrical Characteristics		
Average forward current	I _{F(AV)} 240 Amps	T _C = 122°C, Square wave, R _{θJC} = .24°C/W
Maximum surge current	I _{FSM} 3300 Amps	8.3ms, half sine, T _J = 175°C
Maximum repetitive reverse current	I _{R(OV)} 2 Amps	f = 1 KHZ, 25°C
Max peak forward voltage	V _{FM} 0.72 Volts	I _{FM} = 240A: T _J = 175°C*
Max peak forward voltage	V _{FM} 0.86 Volts	I _{FM} = 240A: T _J = 25°C*
Max peak reverse current	I _{RM} 200mA	V _{RRM} , T _J = 125°C*
Max peak reverse current	I _{RM} 8.0mA	V _{RRM} , T _J = 25°C
Typical junction capacitance	C _J 6400pF	V _R = 5.0V, T _C = 25°C

*Pulse test: Pulse width 300 usec, Duty cycle 2%

Thermal and Mechanical Characteristics		
Storage temp range	T _{STG}	-55°C to 175°C
Operating junction temp range	T _J	-55°C to 175°C
Max thermal resistance	R _{θJC}	0.24°C/W Junction to case
Typical thermal resistance (greased)	R _{θCS}	0.12°C/W Case to sink
Terminal Torque		35-40 inch pounds
Mounting Base Torque		20-25 inch pounds
Weight		1.1 ounces (32 grams) typical

HS24380 – HS243100

Figure 1
Typical Forward Characteristics

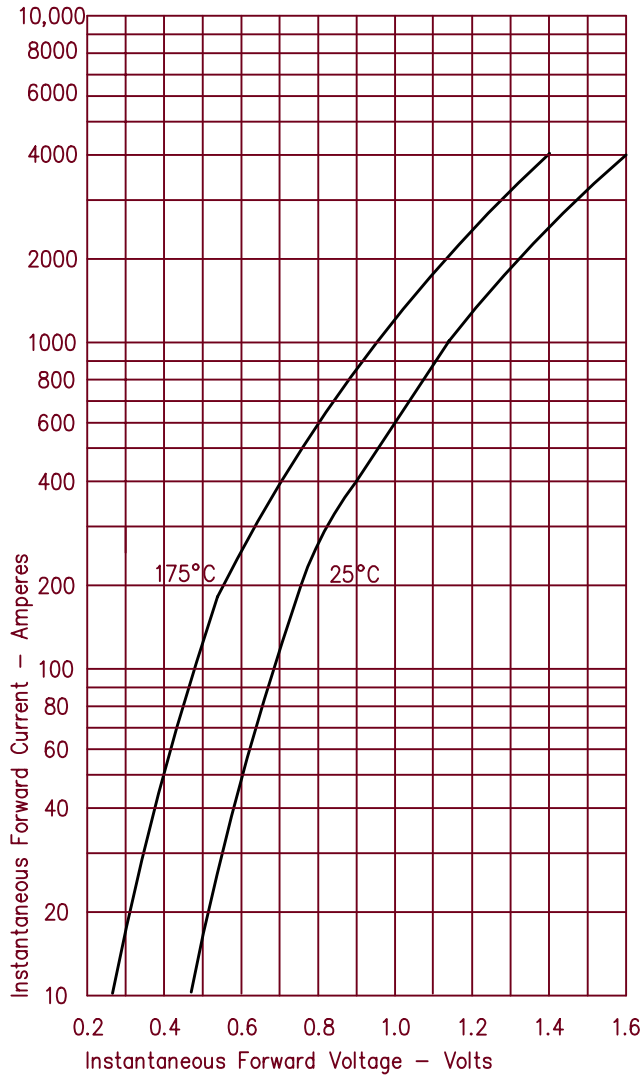

Figure 3
Typical Junction Capacitance

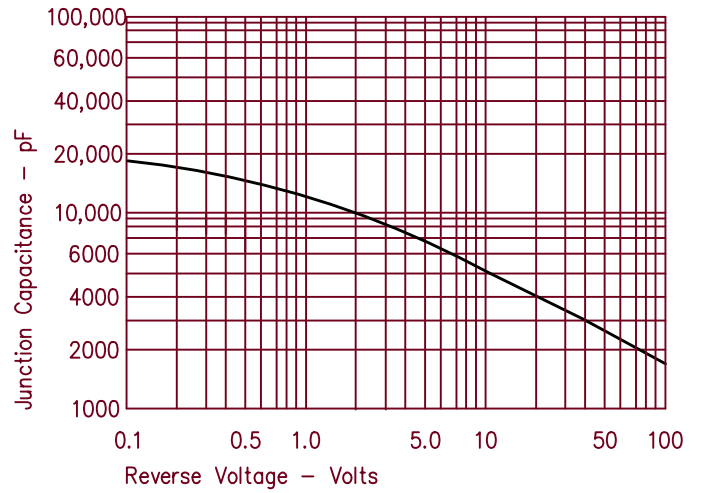

Figure 4
Forward Current Derating

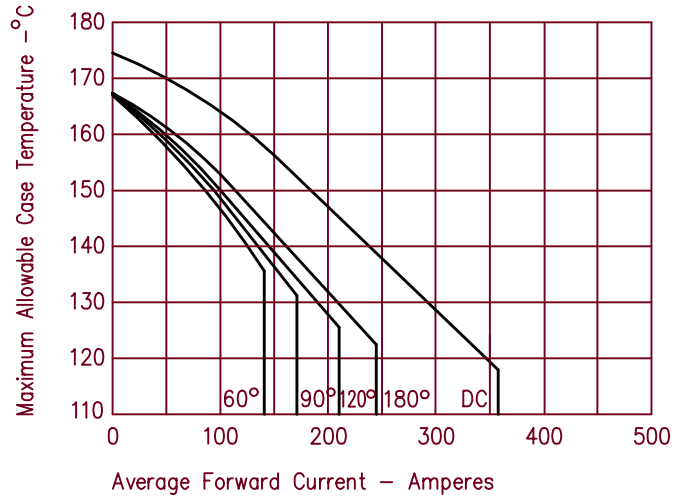

Figure 2
Typical Reverse Characteristics

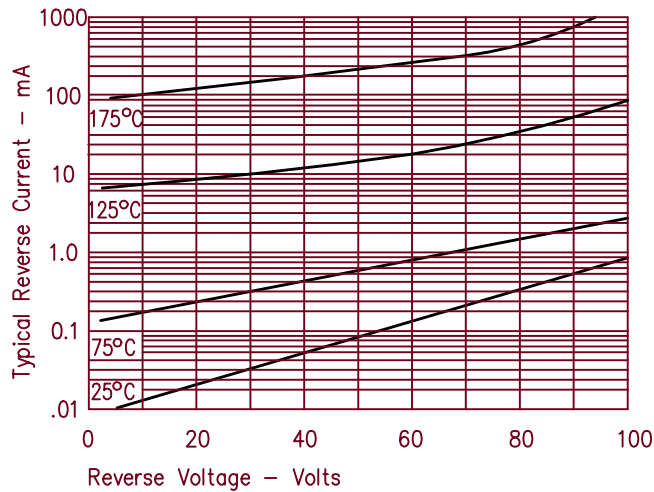
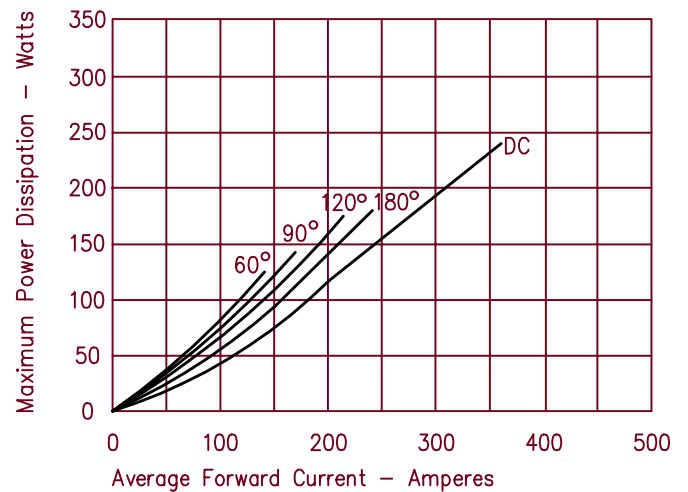

Figure 5
Maximum Forward Power Dissipation





LittleDiode supplies new, hard to find or obsolete electronic components and semiconductors all over the world.

With over two million different components listed you are sure to find the part you need.

Feel free to visit us today at our online store:

LittleDiode.com

Looking forward to providing you with the best possible service.